







# ROLLER BLINDS L

Data sheets

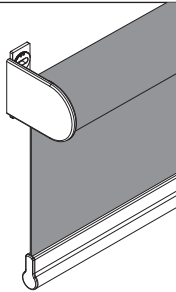
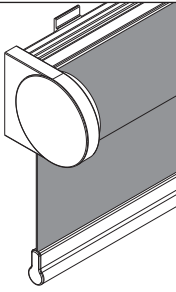
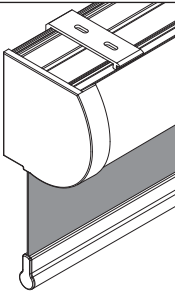
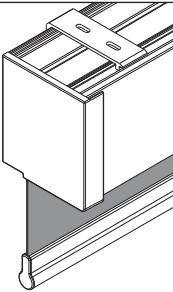

BENTHIN

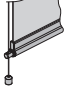

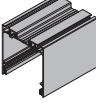
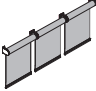
		Roller Blinds System L			
		Bracket	Mounting profile	Cassette round	Cassette angular
					
max. dimensions (depending on fabric)		4.00 x 4.00 m	4.00 x 4.00 m	4.00 x 4.00 m	4.00 x 4.00 m
Operation	 Chain	<b>RL01</b> Page 4-5	<b>RL11</b> Page 10-11	<b>RL21</b> Page 16-19	<b>RL31</b> Page 28-31
	 Motor	<b>RL06</b> Page 6-7	<b>RL16</b> Page 12-13	<b>RL26</b> Page 20-23	<b>RL36</b> Page 32-35
	 Crank	<b>RL07</b> Page 8-9	<b>RL17</b> Page 14-15	<b>RL27</b> Page 24-27	<b>RL37</b> Page 36-39
Side guiding	 Cord guide	RL01 RL06 RL07	RL11 RL16 RL17	RL21 RL26 RL27	RL31 RL36 RL37
	 Side profile			RL21 RL26 RL27	RL31 RL36 RL37
Others	 Recess profile	RL01 RL06 Page 40-43			
	 Coupling	RL01 RL06 RL07	RL11 RL16 RL17	RL21 RL26 RL27	RL31 RL36 RL37

## RL01 - Large Roller blind with mounting bracket and lateral chain operation

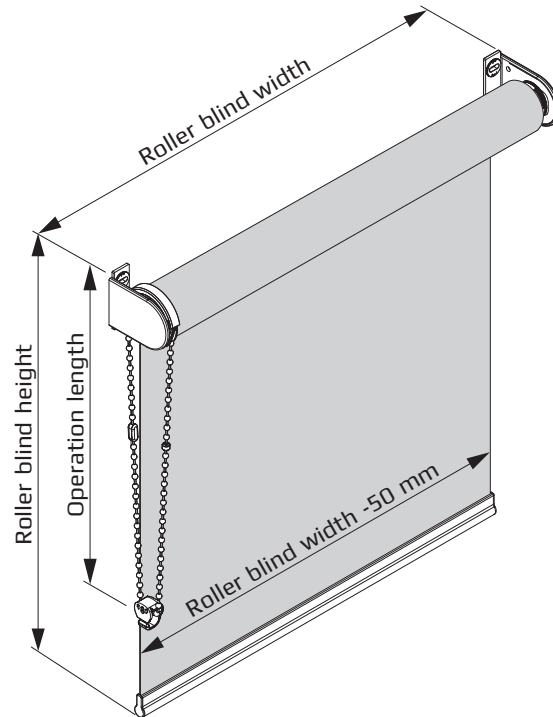

**Child safety:**  
for further informations  
please refer to page 44-45

#### Dimensions/ Roller blind measures

- **Width** : max. 4.00 m (depending on the fabric)
- **Height** : max. 4.00 m (depending on the fabric)
- **Fabric** : max. 12.0 kg

#### Gear/Hardware

- **Side pulley** with a cord lock via spring clutch.  
The spring clutch enables an exact, free positioning of the fabric in any desired position. An additional lift assistance spring enables an easier operation of heavy-weight fabrics.
- **High-precision tube shaft** (Ø43 / Ø52 / Ø65 mm) is made of extruded aluminium (Al Mg Si 0.5 F22).
- **Closing profile** (18 x 36 mm) is made of extruded aluminium (Al Mg Si 0.5 F22) and applicable for the cord guiding, tight brushes are usable.  
Additional weightening by steel profiles is possible.
- **Plastic parts** used are of high-grade, temperatur-resistant and abrasion-resistant material.
- **Cord guiding** at up to a max. 15° angle.  
Steel cord, transparently plastic-coated (Ø2.0 mm).

#### Operation

- **Chain operation**  
by an **endless ball chain** (Ø6.0 mm x 12.0 mm) - plastic balls on a polyester cord in transparent/white, transparent/grey or transparent/black.  
Optional **metal ball chain** (Ø4.5 x 6.0 mm) made of nickel-plated brass or stainless steel or plastic ball chain (Ø4.5 x 6.0 mm) in white, black, grey and beige.
- **Final position limitation** through chain stopper in transparent.
- **Operation side:** optional left or right.
- **Fixation** of the chain operation by through Cord/chain safety device transparent. or the use of a chain securing device (no final position limitation through chain stopper).
- **Operation length:** freely selectable (In compliance with child safety).

#### Colours

- **Closing profile** (18 x 36 mm) is technically anodised according to E6/EV1 in silver or powder-coated white (RAL 9016), black (RAL 9005), grey (RAL 9006) or beige (RAL 1013).
- **Fixing brackets** are made of galvanized steel.
- Matching **Plastic parts** in white, black, grey and beige.

#### Mounting

- **Mounting with universal bracket** on the wall, ceiling or reveal.
- **Cord guiding** screwed directly on the bracket or with the angle (galvanized and white).

#### Option

- **Coupling**  
Up to three systems of the same type with an integrated operation.  
Total width: max. 6.0m, Total area: max. 16 m²,  
The fabric weight is depending on the operation variant and the diameter of the shaft  
7.0 kg - 12.0 kg.

## RL01 - Large Roller blind with mounting bracket and lateral chain operation

## Mounting

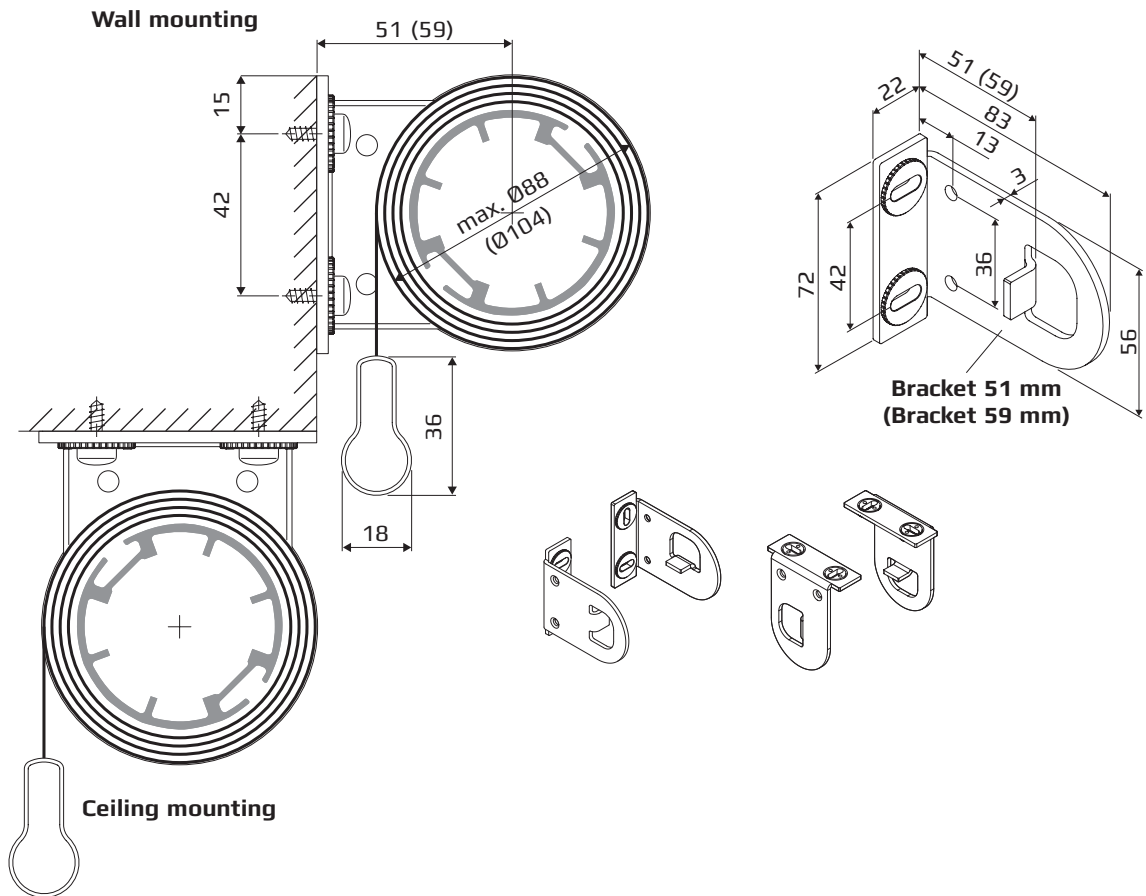

## Cord guiding

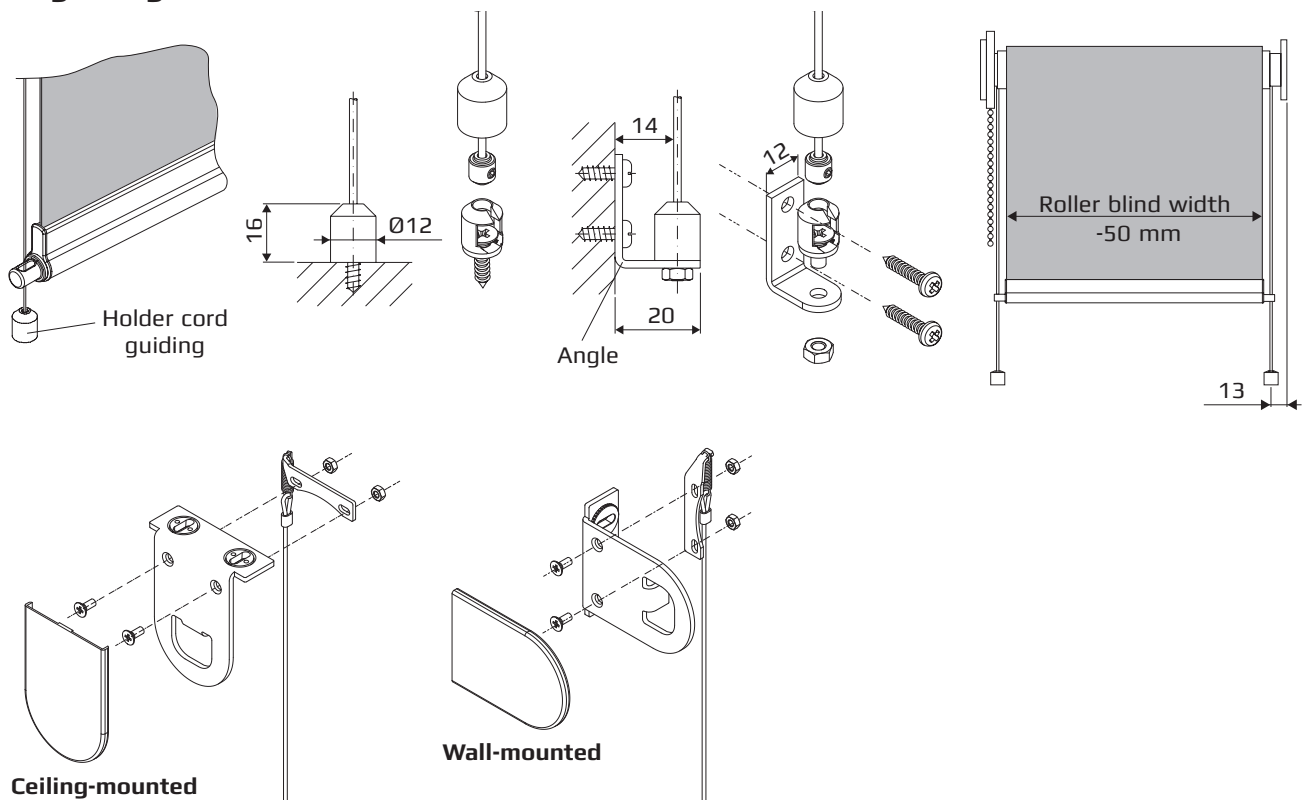

## RL06 - Large Roller blind with mounting bracket and motor operation

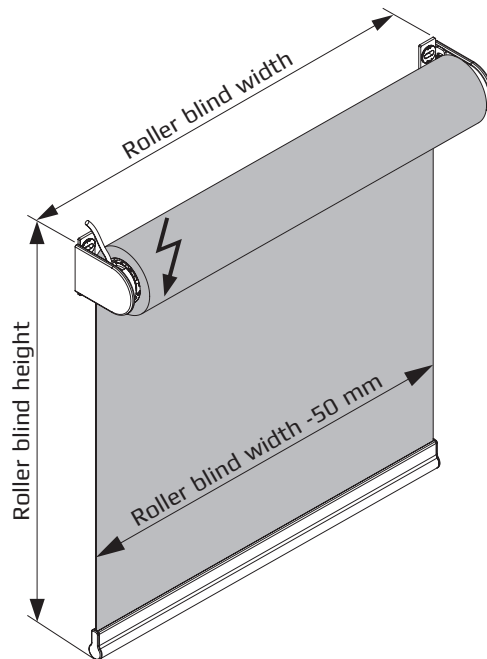

#### Dimensions/ Roller blind measures

- **Width** : max. 4.00 m (depending on the fabric)
- **Height** : max. 4.00 m (depending on the fabric)
- **Fabric** : max. 12.0 kg (depending on the motor)

#### Gear/Hardware

- **Motor drive** in the roller blind shaft.  
The blind can be operated by a switch or remote control to enable an exact, free adjustment of the fabric in any desired position.
- **High-precision tube shaft** (Ø43 / Ø52 / Ø65 / Ø75 mm) is made of extruded aluminium (Al Mg Si 0.5 F22).
- **Closing profile** (18 x 36 mm) is made of extruded aluminium (Al Mg Si 0.5 F22) and applicable for the cord guiding, tight brushes are usable.  
Additional weightening by steel profiles is possible.
- **Plastic parts** used are of high-grade, temperatur-resistant and abrasion-resistant material.
- **Cord guiding** at up to a max. 15° angle.  
Steel cord, transparently plastic-coated (Ø2.0 mm).

#### Operation

- **Plug-in drive SOMFY Sonesse 40 – 230 V**  
suitable for the Ø52 or Ø65 mm tube shaft.  
Protection class: IP 44, rated torque: 3/6 Nm, rated speed: 30/20 rpm, rated voltage: 230 V, rate: 50 Hz, max. power consumption 0.44/0.55 A, rated power: 95/120 W, weight: 1.125/1.25 kg, length: 478/510 mm, connection: 2.5 m cable (3 x 0.75 mm²).
- **Plug-in drive SOMFY Sonesse 40 RTS – 230 V**  
suitable for the Ø52 or Ø65 mm tube shaft.  
Protection class: IP 44, rated torque: 3/6 Nm, rated speed: 30/20 rpm, rated voltage: 230 V, rate: 50 Hz, max. power consumption 0.44/0.55 A, rated power: 95/120 W, weight: 1.225/1.25 kg, length: 517/548 mm, connection: 3.0 m cable (3 x 0.75 mm²).
- **Plug-in drive SOMFY LT 50 Start – 230 V**  
suitable for the Ø65 or Ø75 mm tube shaft.  
Protection class: IP 44, rated torque: 6 Nm, rated speed: 17 rpm, rated voltage: 230 V, rate: 50 Hz, max. power consumption 0.45 A, rated power: 90 W, weight: 1.72 kg, length: 513 mm, connection: 3.0 m cable (4 x 0.75 mm²).
- **Plug-in drive SOMFY 50 RTS Sonesse – 230 V**  
suitable for the Ø65 mm or Ø75 mm tube shaft.  
Protection class: IP 31, rated torque: 3 Nm, rated speed: 28 rpm, rated voltage: 230 V, rate: 50 Hz, max. power consumption 0.4 A, rated power: 90 W, weight: 2.8 kg, length: 783 mm, connection: 3.0 m cable (4 x 0.75 mm²).
- **Motor side:** optional left or right.

#### Colours

- **Closing profile** (18 x 36 mm) is technically anodised according to E6/EV1 in silver or powder-coated white (RAL 9016), black (RAL 9005), grey (RAL 9006) or beige (RAL 1013).
- **Fixing brackets** are made of galvanized steel.
- Matching **Plastic parts** in white, black, grey and beige.

#### Mounting

- **Mounting with universal bracket** on the wall, ceiling or reveal.
- **Cord guiding** screwed directly on the bracket or with the angle (galvanized and white).

## RL06 - Large Roller blind with mounting bracket and motor operation

### Option

#### • Coupling

Up to three systems of the same type with an integrated operation.

Total width: max. 6.0m, Total area: max. 16 m<sup>2</sup>,

The fabric weight is depending on the operation variant and the diameter of the shaft  
7.0 kg - 12.0 kg.

### Mounting

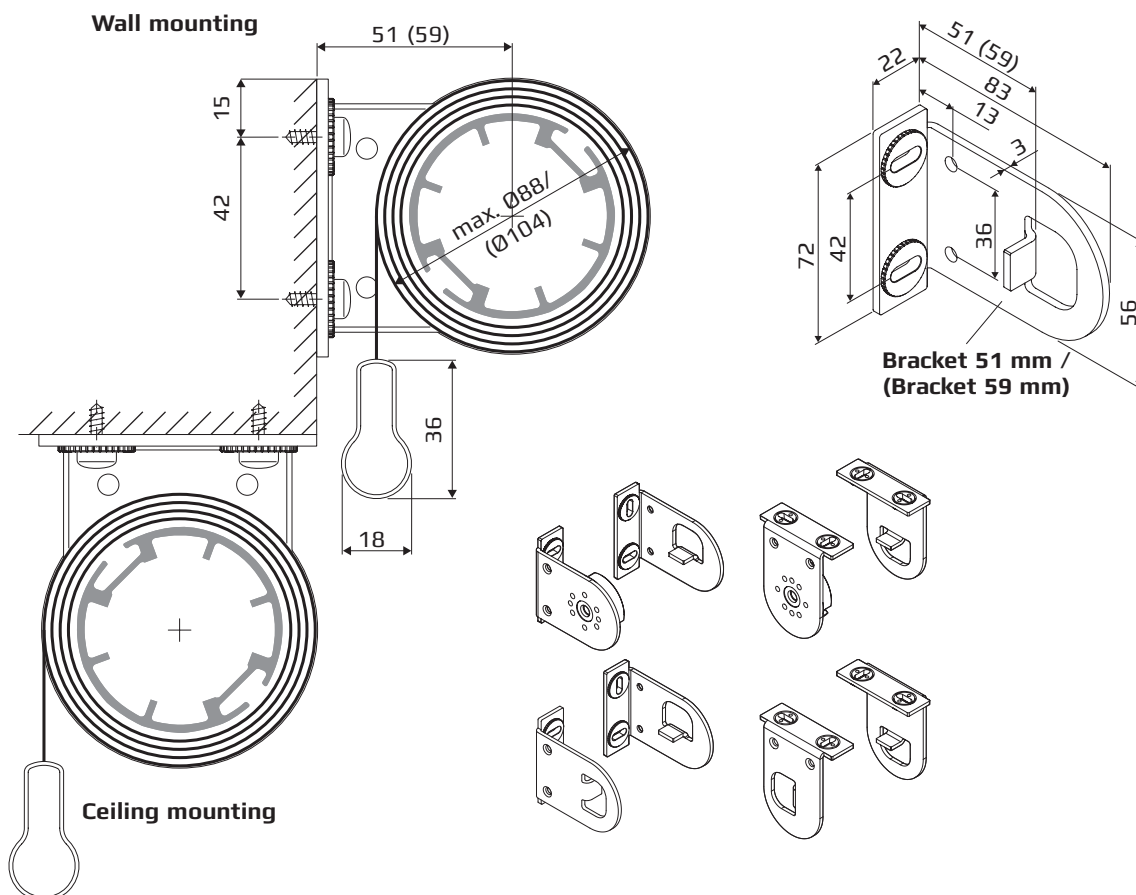

### Cord guiding

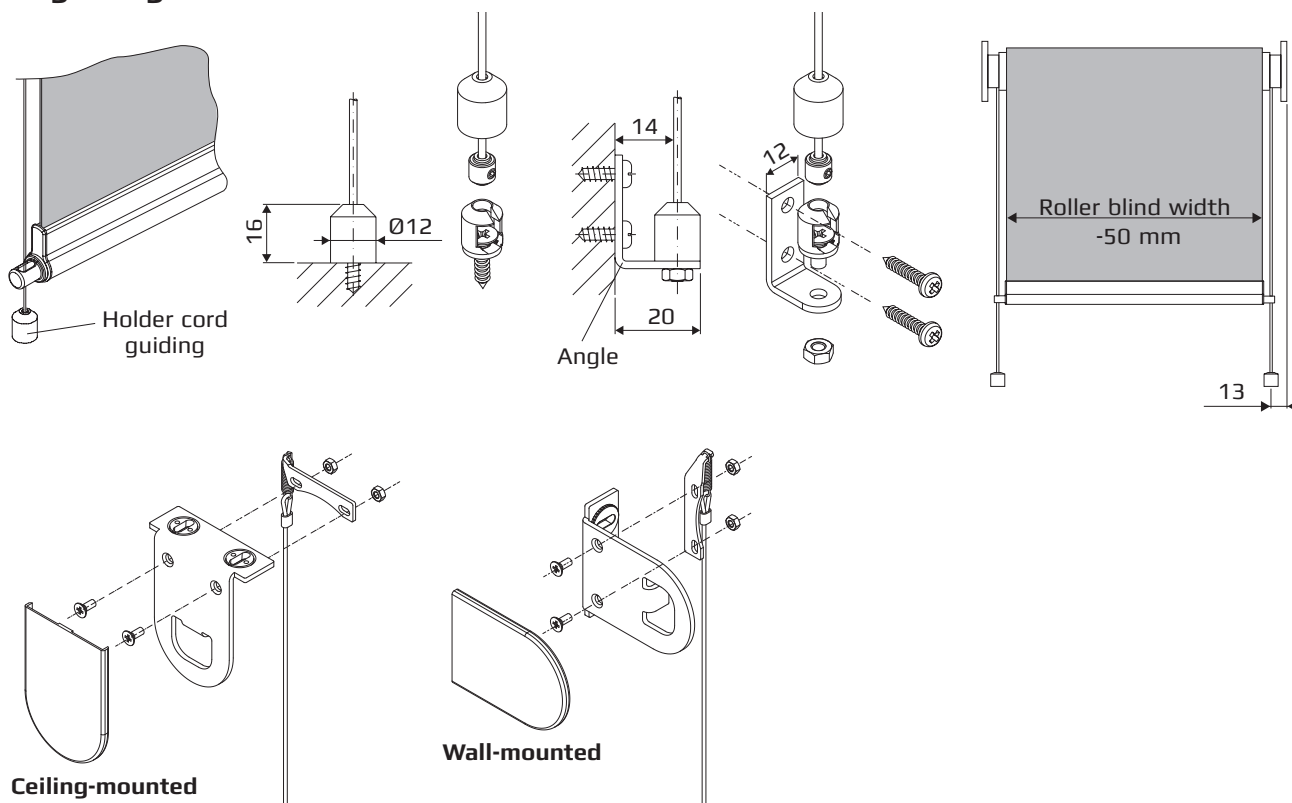

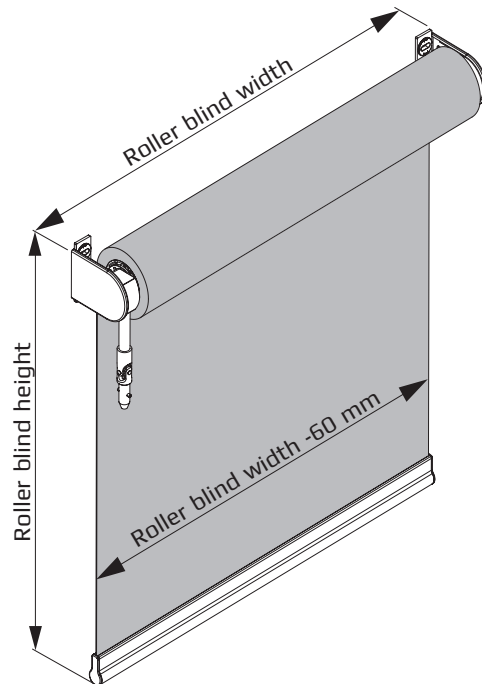

## RL07 - Large Roller blind with mounting bracket and lateral crank operation

**Dimensions/  
Roller blind measures**

- **Width** : max. 4.00 m (depending on the fabric)
- **Height** : max. 4.00 m (depending on the fabric)
- **Fabric** : max. 12.0 kg

**Gear/Hardware**

- **Crank gear box** with an attachable collapsible handle in white or grey.  
The operation is quick, quiet and even. Exact, stepless adjustment of the fabric in any desired position.
- **High-precision tube shaft** (Ø43 / Ø52 / Ø65 mm) is made of extruded aluminium (Al Mg Si 0.5 F22).
- **Closing profile** (18 x 36 mm) is made of extruded aluminium (Al Mg Si 0.5 F22) and applicable for the cord guiding, tight brushes are usable.  
Additional weighting by steel profiles is possible.
- **Plastic parts** used are of high-grade, temperatur-resistant and abrasion-resistant material.
- **Cord guiding** at up to a max. 15° angle.  
Steel cord, transparently plastic-coated (Ø2.0 mm).

**Operation**

- **Crank mechanism with an attachable collapsible handle**  
Gear ratio of 4:1  
Tube shafts Ø43 mm and Ø52 mm: adjustable end position with double end stop and integrated overload protection (depending on the curtain weight).  
Tube shaft Ø65 mm: collapsible handle with overload protection.  
Crank outlet on the wall 30°, on the ceiling 30° forward.  
Collapsible handle, overall length of 1.5 m, 2.0 m or 2.5 m.
- **Operation side:** optional left or right.

**Colours**

- **Closing profile** (18 x 36 mm) is technically anodised according to E6/EV1 in silver or powder-coated white (RAL 9016), black (RAL 9005), grey (RAL 9006) or beige (RAL 1013).
- **Fixing brackets** are made of galvanized steel.
- Matching **Plastic parts** in white, black, grey and beige.
- **Collapsible handle:** technically anodised according to E6/EV1 in silver or powder-coated white (RAL 9016), Holder for crank handle in white or grey.

**Mounting**

- **Mounting with universal bracket** on the wall, ceiling or reveal.
- **Cord guiding** screwed directly on the bracket or with the angle (galvanized and white).

**Option**

- **Coupling**  
Up to three systems of the same type with an integrated operation.  
Total width: max. 6.0m, Total area: max. 16 m²,  
The fabric weight is depending on the operation variant and the diameter of the shaft  
7.0 kg - 12.0 kg.



## RL07 - Large Roller blind with mounting bracket and lateral crank operation

## Mounting

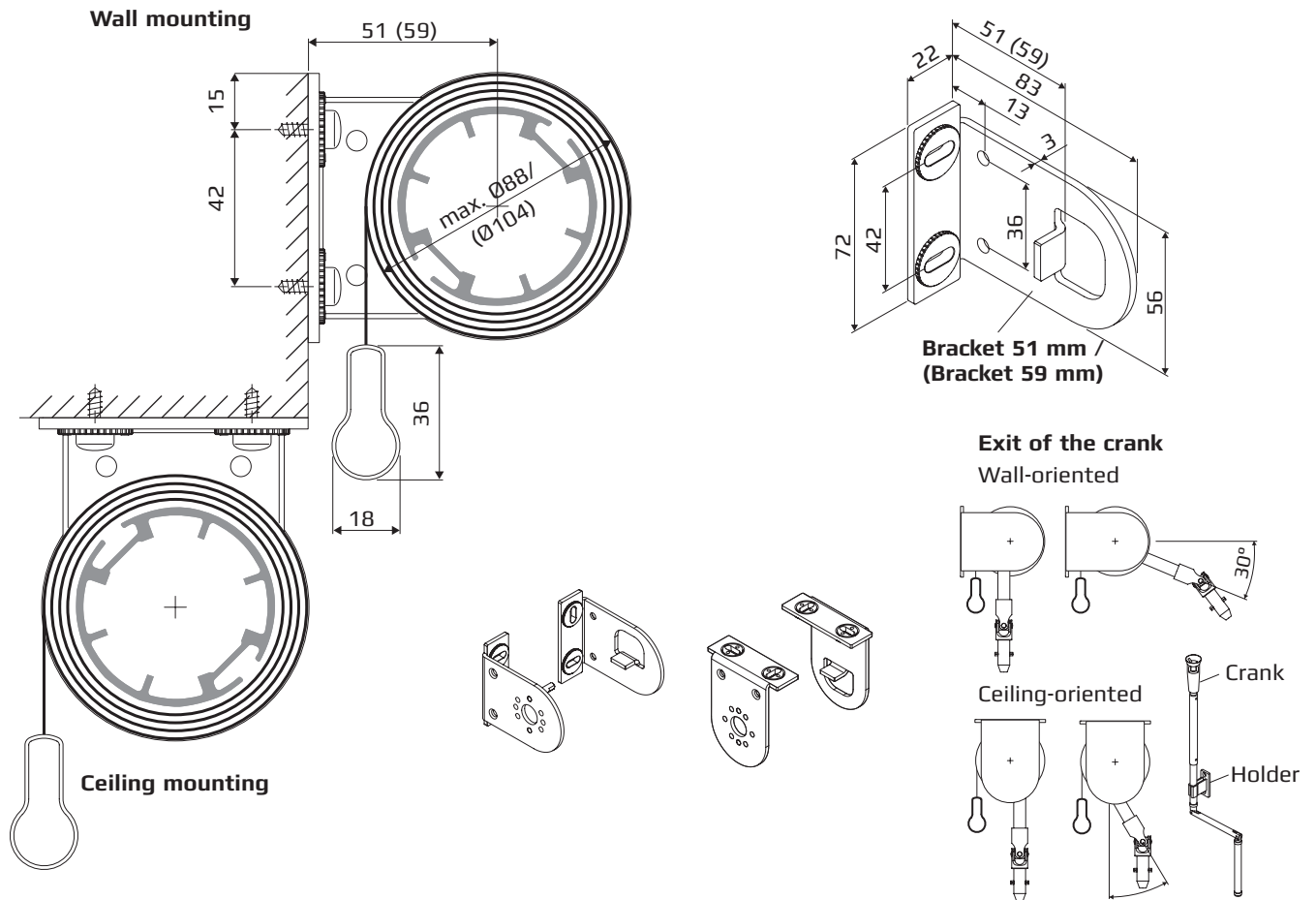

## Cord guiding

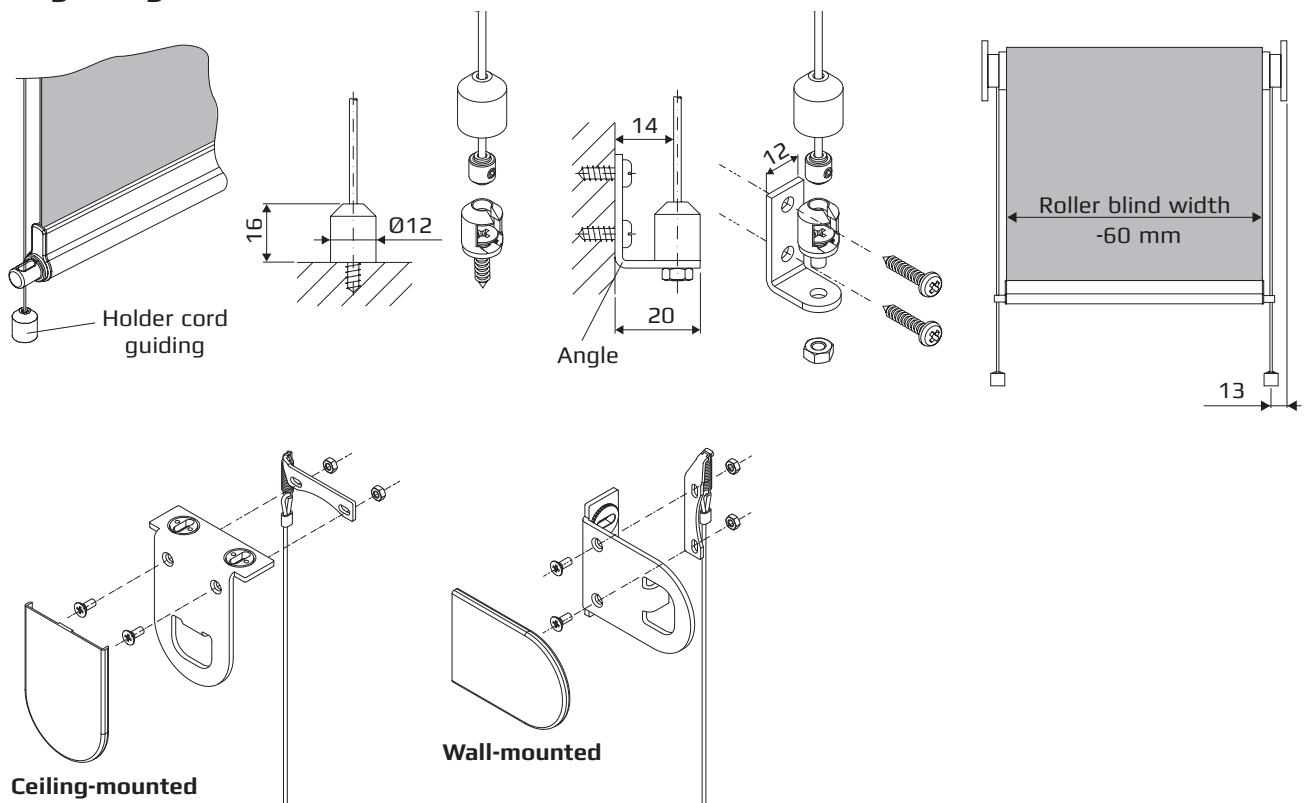

## RL11 - Large Roller blind with Mounting profile and lateral chain operation

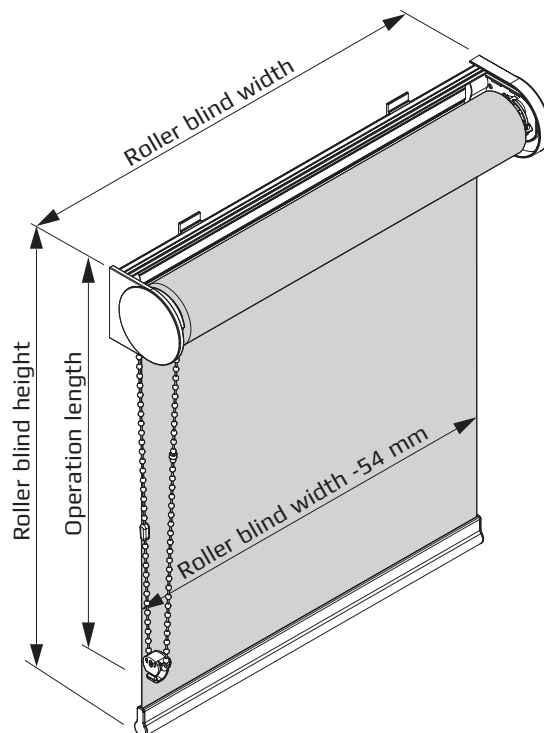

**Child safety:**  
for further informations  
please refer to page 44-45

### Dimensions/ Roller blind measures

- **Width** : max. 4.00 m (depending on the fabric)
- **Height** : max. 4.00 m (depending on the fabric)
- **Fabric** : max. 12.0 kg

### Gear/Hardware

- **Side pulley** with a cord lock via spring clutch.  
The spring clutch enables an exact, free positioning of the fabric in any desired position. An additional lift assistance spring enables an easier operation of heavy-weight fabrics.
- **Mounting profile** (87 x 33 mm) is made of extruded aluminium (Al Mg Si 0,5 F22).
- **High-precision tube shaft** (Ø43 / Ø52 / Ø65 mm) is made of extruded aluminium (Al Mg Si 0.5 F22).
- **Closing profile** (18 x 36 mm) is made of extruded aluminium (Al Mg Si 0.5 F22) and applicable for the cord guiding, tight brushes are usable.  
Additional weightening by steel profiles is possible.
- **Plastic parts** used are of high-grade, temperatur-resistant and abrasion-resistant material.
- **Cord guiding** at up to a max. 15° angle.  
Steel cord, transparently plastic-coated (Ø2.0 mm).

### Operation

- **Chain operation**  
by an **endless ball chain** (Ø6.0 mm x 12.0 mm) - plastic balls on a polyester cord in transparent/white, transparent/grey or transparent/black.  
Optional **metal ball chain** (Ø4.5 x 6.0 mm) made of nickel-plated brass or stainless steel or plastic ball chain (Ø4.5 x 6.0 mm) in white, black, grey and beige.
- **Final position limitation** through chain stopper in transparent.
- **Operation side:** optional left or right.
- **Fixation** of the chain operation by through Cord/chain safety device transparent.  
or the use of a chain securing device (no final position limitation through chain stopper).
- **Operation length:** freely selectable (In compliance with child safety).

### Colours

- **Mounting profile** (87 x 33 mm), **Closing profile** (18 x 36 mm) and **Fixing brackets** (86 x 30 mm) are technically anodised according to E6/EV1 in silver or powder-coated white (RAL 9016), black (RAL 9005), grey (RAL 9006) or beige (RAL 1013).
- Matching **Plastic parts** in white, black, grey and beige.

### Mounting

- **Mounting with bracket** on the wall or ceiling.
- **Cord guiding** screwed directly on the bracket or with the angle (galvanized and white).

### Option

- **Coupling**  
Up to three systems of the same type with an integrated operation.  
Total width: max. 6.0m, Total area: max. 16 m²,  
The fabric weight is depending on the operation variant and the diameter of the shaft  
7.0 kg - 12.0 kg.

## RL11 - Large Roller blind with Mounting profile and lateral chain operation

## Mounting

Ceiling mounting

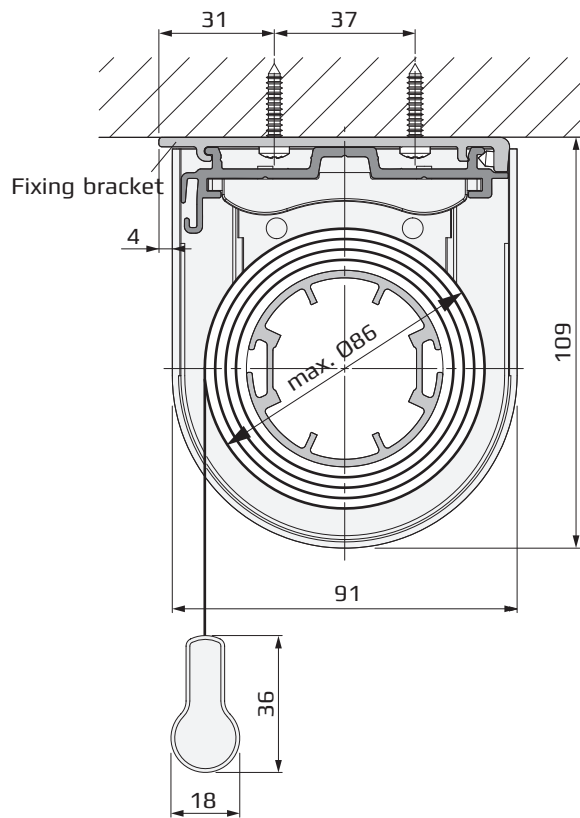

Wall mounting

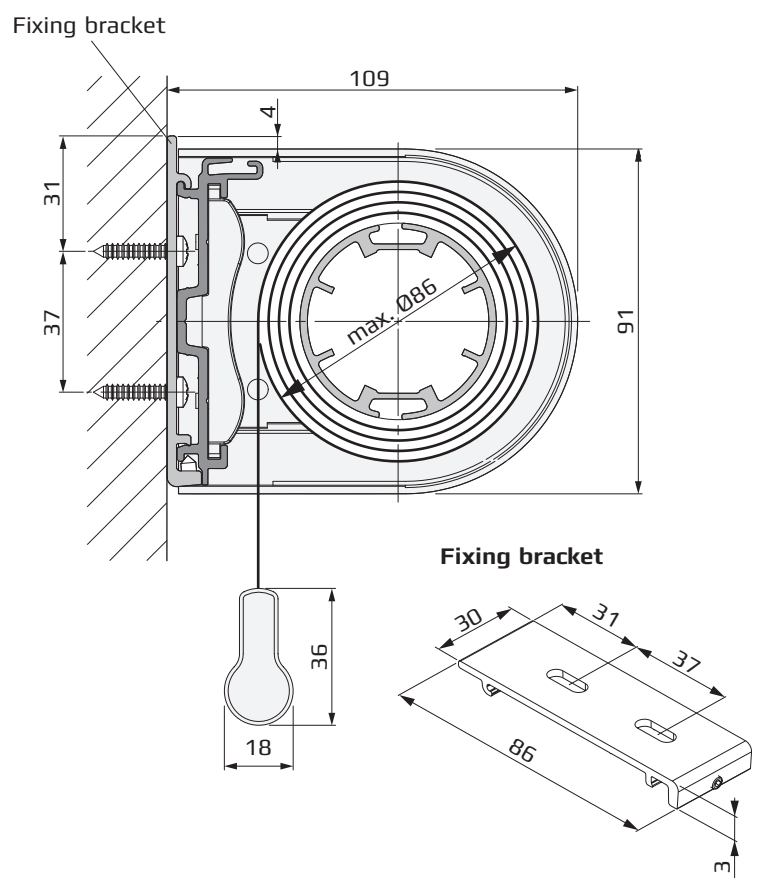

## Cord guiding

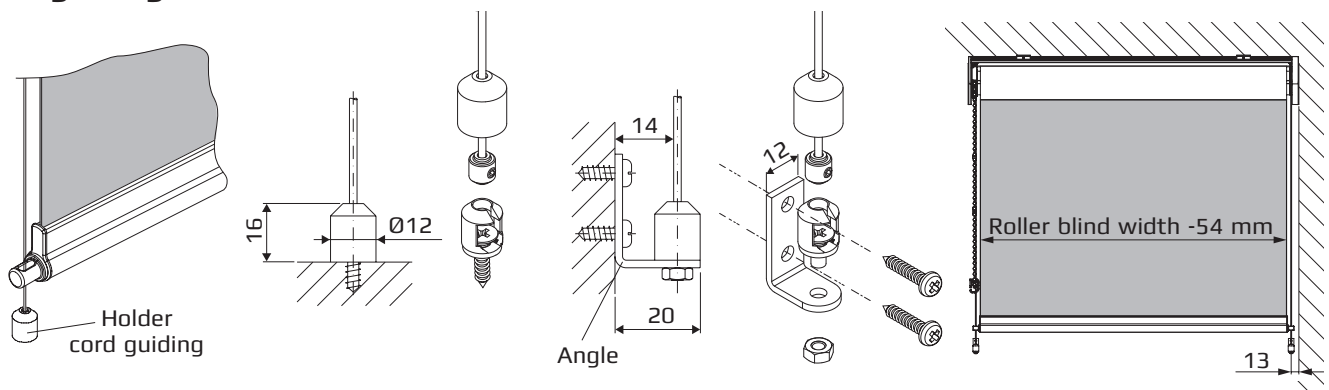

## RL16 - Large Roller blind with mounting profile and motor operation

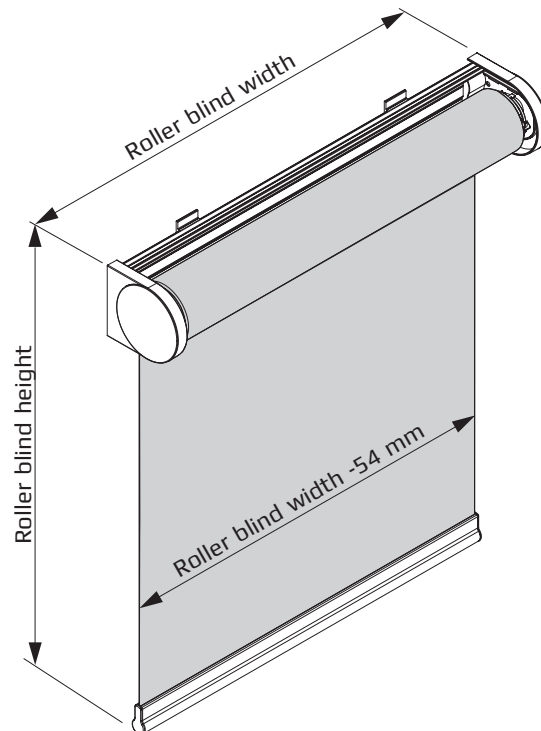

### Dimensions/ Roller blind measures

- **Width** : max. 4.00 m (depending on the fabric)
- **Height** : max. 4.00 m (depending on the fabric)
- **Fabric** : max. 12.0 kg

### Gear/Hardware

- **Motor drive** in the roller blind shaft.  
The blind can be operated by a switch or remote control to enable an exact, free adjustment of the fabric in any desired position.
- **Mounting profile** (87 x 33 mm) is made of extruded aluminium (Al Mg Si 0,5 F22).
- **High-precision tube shaft** (Ø52 / Ø65 / Ø75 mm) is made of extruded aluminium (Al Mg Si 0.5 F22).
- **Closing profile** (18 x 36 mm) is made of extruded aluminium (Al Mg Si 0.5 F22) and applicable for the cord guiding, tight brushes are usable.  
Additional weightening by steel profiles is possible.
- **Plastic parts** used are of high-grade, temperatur-resistant and abrasion-resistant material.
- **Cord guiding** at up to a max. 15° angle.  
Steel cord, transparently plastic-coated (Ø2.0 mm).

### Operation

- **Plug-in drive SOMFY Sonesse 40 – 230 V**  
suitable for the Ø52 or Ø65 mm tube shaft.  
Protection class: IP 44, rated torque: 3/6 Nm, rated speed: 30/20 rpm, rated voltage: 230 V, rate: 50 Hz, max. power consumption 0.44/0.55 A, rated power: 95/120 W, weight: 1.125/1.25 kg, length: 478/510 mm, connection: 2.5 m cable (3 x 0.75 mm²).
- **Plug-in drive SOMFY Sonesse 40 RTS – 230 V**  
suitable for the Ø52 or Ø65 mm tube shaft.  
Protection class: IP 44, rated torque: 3/6 Nm, rated speed: 30/20 rpm, rated voltage: 230 V, rate: 50 Hz, max. power consumption 0.44/0.55 A, rated power: 95/120 W, weight: 1.225/1.25 kg, length: 517/548 mm, connection: 3.0 m cable (3 x 0.75 mm²).
- **Plug-in drive SOMFY LT 50 Start – 230 V**  
suitable for the Ø65 or Ø75 mm tube shaft.  
Protection class: IP 44, rated torque: 6 Nm, rated speed: 17 rpm, rated voltage: 230 V, rate: 50 Hz, max. power consumption 0.45 A, rated power: 90 W, weight: 1.72 kg, length: 513 mm, connection: 3.0 m cable (4 x 0.75 mm²).
- **Plug-in drive SOMFY 50 RTS Sonesse – 230 V**  
suitable for the Ø65 mm or Ø75 tube shaft.  
Protection class: IP 31, rated torque: 3 Nm, rated speed: 28 rpm, rated voltage: 230 V, rate: 50 Hz, max. power consumption 0.4 A, rated power: 90 W, weight: 2.8 kg, length: 783 mm, connection: 3.0 m cable (4 x 0.75 mm²).
- **Motor side:** optional left or right.

## RL16 - Large Roller blind with mounting profile and motor operation

### Colours

- **Mounting profile** (87 x 33 mm), **Closing profile** (18 x 36 mm) and **Fixing brackets** (86 x 30 mm) are technically anodised according to E6/EV1 in silver or powder-coated white (RAL 9016), black (RAL 9005), grey (RAL 9006) or beige (RAL 1013).
- Matching **Plastic parts** in white, black, grey and beige.

### Mounting

- **Mounting with bracket** on the wall or ceiling.
- **Cord guiding** screwed directly on the bracket or with the angle (galvanized and white).

### Option

- **Coupling**  
Up to three systems of the same type with an integrated operation.  
Total width: max. 6.0m, Total area: max. 16 m<sup>2</sup>,  
The fabric weight is depending on the operation variant and the diameter of the shaft  
7.0 kg - 12.0 kg.

## Mounting

### Ceiling mounting

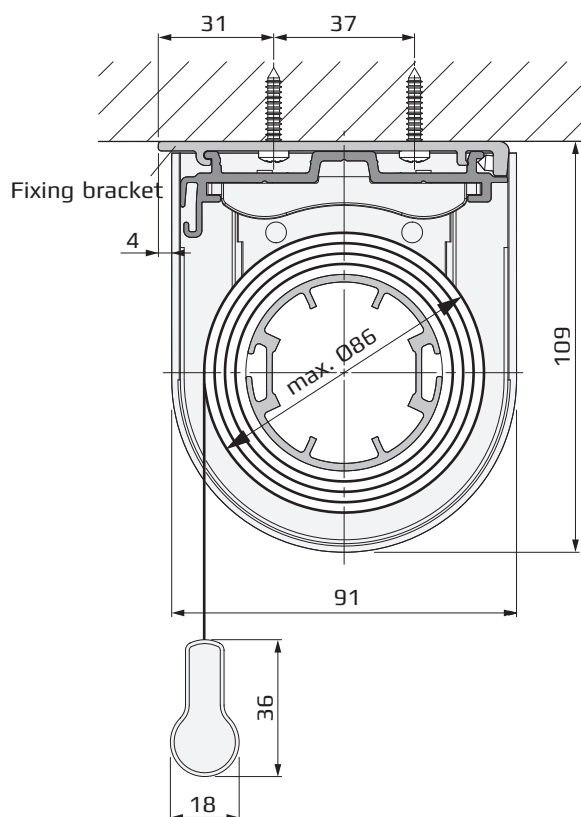

### Wall mounting

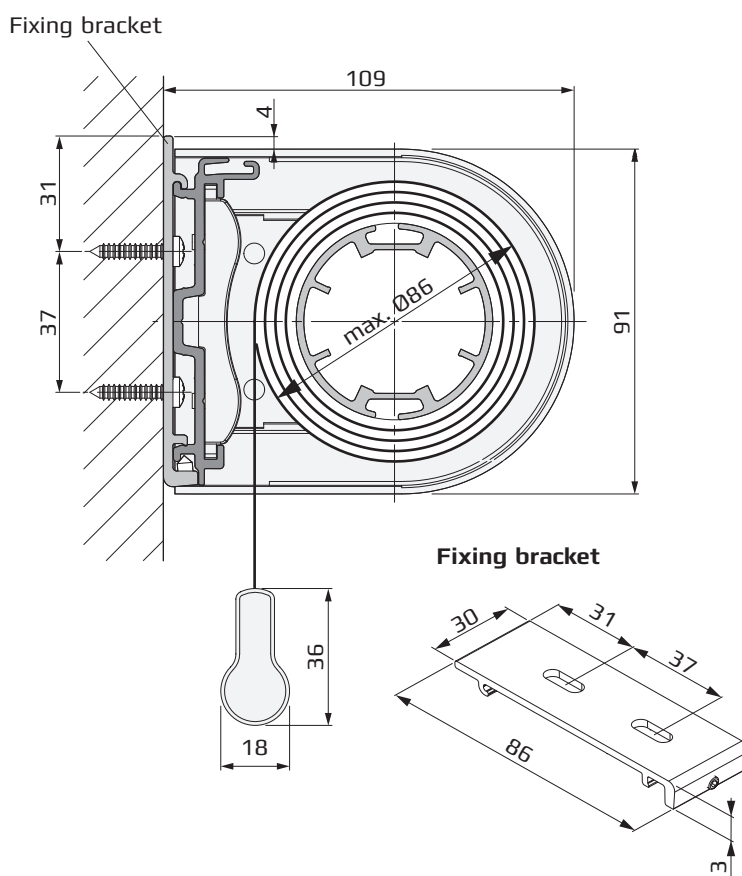

## Cord guiding

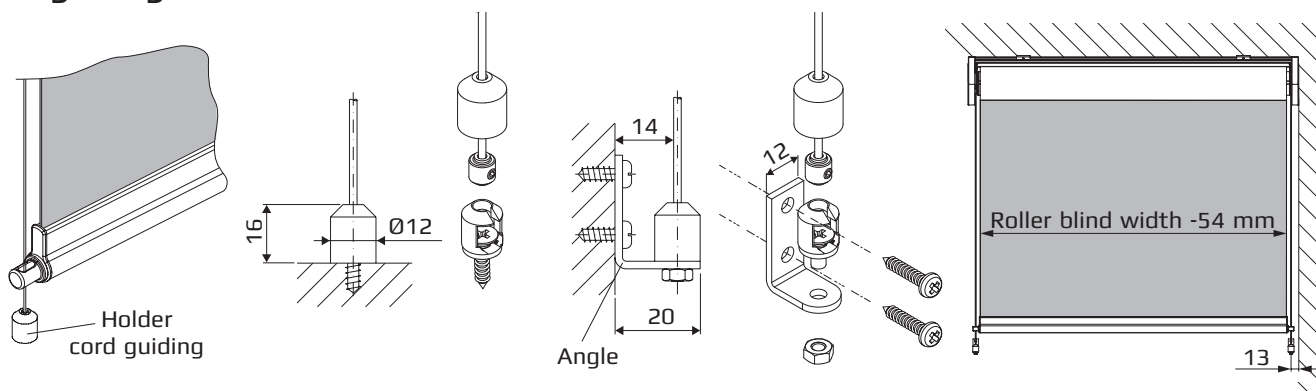

## RL17 - Large Roller blind with mounting profile and lateral crank operation

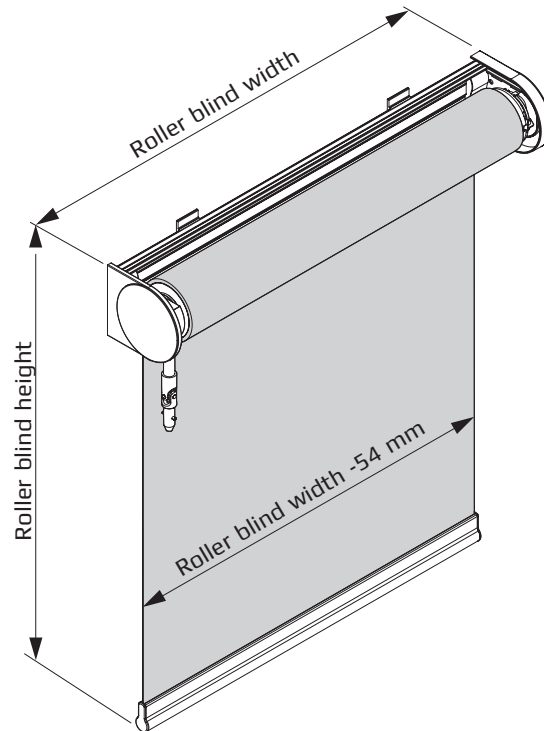
**Dimensions/  
Roller blind measures**

- **Width** : max. 4.00 m (depending on the fabric)
- **Height** : max. 4.00 m (depending on the fabric)
- **Fabric** : max. 12.0 kg

**Gear/Hardware**

- **Crank gear box** with an attachable collapsible handle in white or grey.  
The operation is quick, quiet and even. Exact, stepless adjustment of the fabric in any desired position.
- **Mounting profile** (87 x 33 mm) is made of extruded aluminium (Al Mg Si 0,5 F22).
- **High-precision tube shaft** (Ø43 / Ø52 / Ø65 mm) is made of extruded aluminium (Al Mg Si 0.5 F22).
- **Closing profile** (18 x 36 mm) is made of extruded aluminium (Al Mg Si 0.5 F22) and applicable for the cord guiding, tight brushes are usable.  
Additional weightening by steel profiles is possible.
- **Plastic parts** used are of high-grade, temperatur-resistant and abrasion-resistant material.
- **Cord guiding** at up to a max. 15° angle.  
Steel cord, transparently plastic-coated (Ø2.0 mm).

**Operation**

- **Crank mechanism with an attachable collapsible handle**  
Gear ratio of 4:1  
Tube shafts Ø43 mm and Ø52 mm: adjustable end position with double end stop and integrated overload protection (depending on the curtain weight).  
Tube shaft Ø65 mm: collapsible handle with overload protection.  
Crank outlet on the wall 30°, on the ceiling 30° forward.  
Collapsible handle, overall length of 1.5 m, 2.0 m or 2.5 m.
- **Operation side:** optional left or right.

**Colours**

- **Mounting profile** (87 x 33 mm), **Closing profile** (18 x 36 mm) and **Fixing brackets** (86 x 30 mm) are technically anodised according to E6/EV1 in silver or powder-coated white (RAL 9016), black (RAL 9005), grey (RAL 9006) or beige (RAL 1013).
- Matching **Plastic parts** in white, black, grey and beige.
- **Collapsible handle:** technically anodised according to E6/EV1 in silver or powder-coated white (RAL 9016), Holder for crank handle in white or grey.

**Mounting**

- **Mounting with bracket** on the wall or ceiling.
- **Cord guiding** screwed directly on the bracket or with the angle (galvanized and white).

**Option**

- **Coupling**  
Up to three systems of the same type with an integrated operation.  
Total width: max. 6.0m, Total area: max. 16 m²,  
The fabric weight is depending on the operation variant and the diameter of the shaft  
7.0 kg - 12.0 kg.

# RL17 - Large Roller blind with mounting profile and lateral crank operation

## Mounting

Ceiling mounting

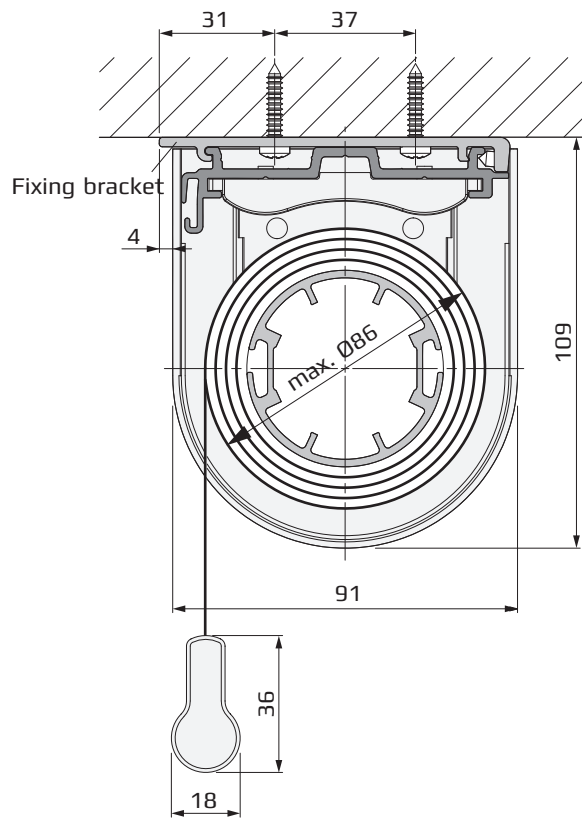

Wall mounting

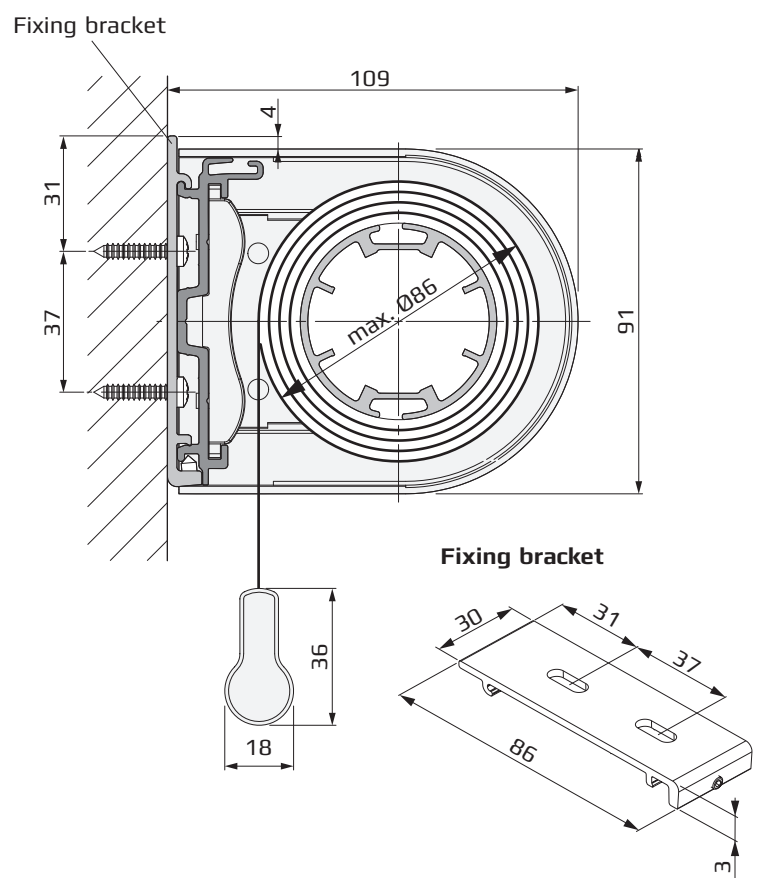

## Exit of the crank

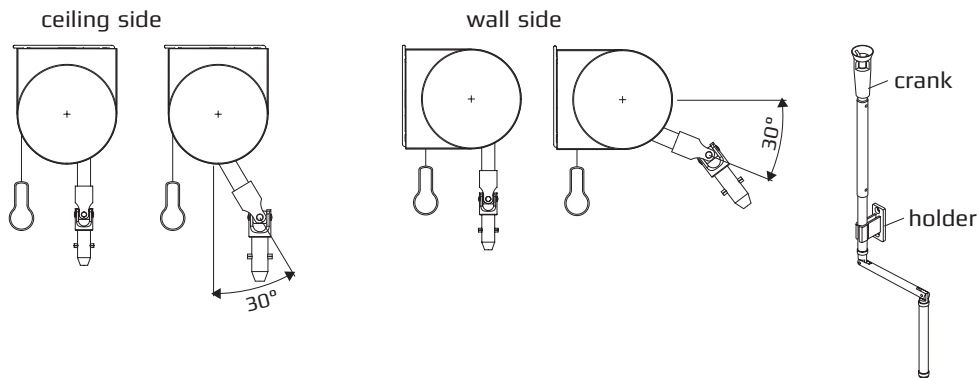

## Cord guiding

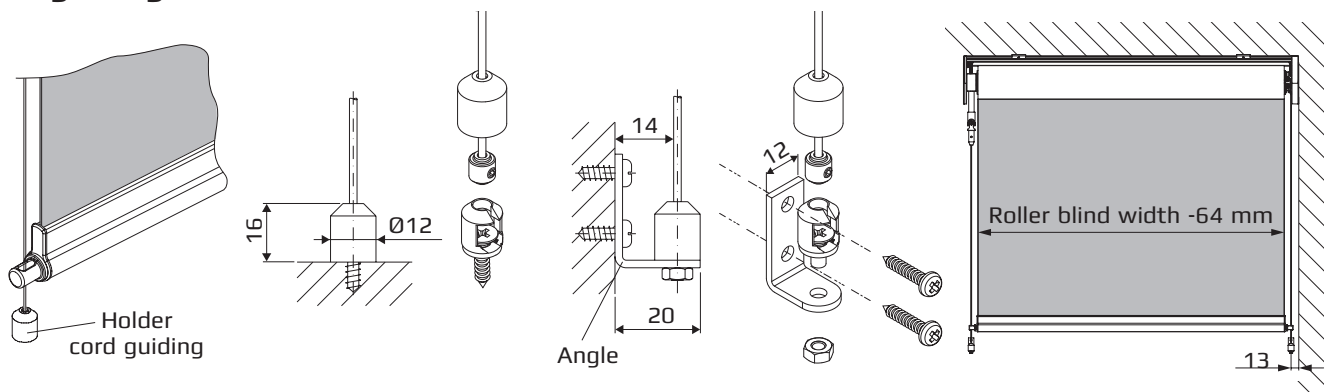



## RL21 - Large Roller blind with round cassette profile and lateral chain operation

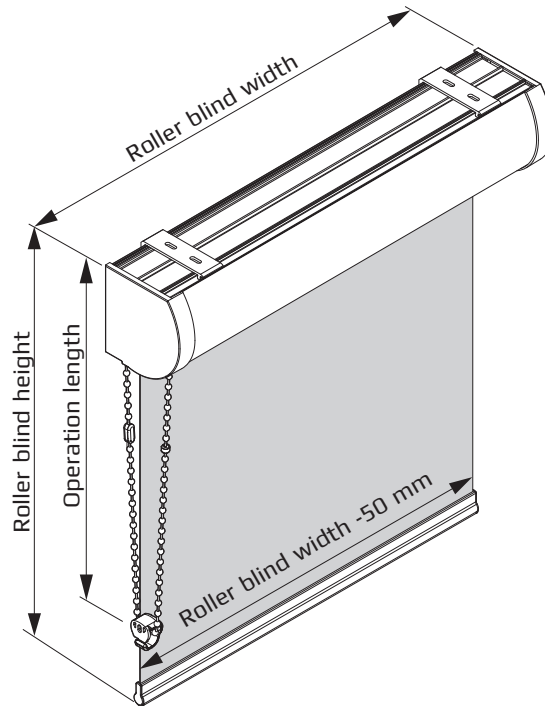

**Child safety:**  
for further informations  
please refer to page 44-45

#### Dimensions/ Roller blind measures

- **Width** : max. 4.00 m (depending on the fabric)
- **Height** : max. 4.00 m (depending on the fabric)
- **Fabric** : max. 12.0 kg

#### Gear/Hardware

- **Side pulley** with a cord lock via spring clutch.  
The spring clutch enables an exact, free positioning of the fabric in any desired position. An additional lift assistance spring enables an easier operation of heavy-weight fabrics.
- **Cassette profile, round** (115 x 120.5 mm) is made of extruded aluminium (Al Mg Si 0.5 F22).
- **High-precision tube shaft** (Ø43 / Ø52 / Ø65 mm) is made of extruded aluminium (Al Mg Si 0.5 F22).
- **Closing profile** (18 x 36 mm) is made of extruded aluminium (Al Mg Si 0.5 F22) and applicable for the cord guiding, tight brushes are usable.  
Additional weighting by steel profiles is possible.
- **Plastic parts** used are of high-grade, temperatur-resistant and abrasion-resistant material.
- **Cord guiding** at up to a max. 15° angle.  
Steel cord, transparently plastic-coated (Ø2.0 mm).
- **Profile guiding**  
The end caps of the closing profile are guided in the profile guiding.  
The fabric extends on both sides into the profile guiding. Inclination angle: max. 15°.  
Measures: cross section = 70 x 27 (47) mm / length = max. 4.00 m. incl. tight brushes.

#### Operation

- **Chain operation**  
by an **endless ball chain** (Ø6.0 mm x 12.0 mm) - plastic balls on a polyester cord in transparent/white, transparent/grey or transparent/black.  
Optional **metal ball chain** (Ø4.5 x 6.0 mm) made of nickel-plated brass or stainless steel or plastic ball chain (Ø4.5 x 6.0 mm) in white, black, grey and beige.
- **Final position limitation** through chain stopper in transparent.
- **Operation side:** optional left or right.
- **Fixation** of the chain operation by through Cord/chain safety device transparent.  
or the use of a chain securing device (no final position limitation through chain stopper).
- **Operation length:** freely selectable (In compliance with child safety).

#### Colours

- **Closing profile** (18 x 36 mm), **Cassette profile** (115 x 120.5 mm) and **Profile guidings** are technically anodised according to E6/EV1 in silver or powder-coated white (RAL 9016), black (RAL 9005), grey (RAL 9006) or beige (RAL 1013).
- **Fixing brackets** are made of galvanized steel.
- Matching **Plastic parts** in white, black, grey and beige.

## RL21 - Large Roller blind with round cassette profile and lateral chain operation

### Mounting

- **Mounting with universal bracket** on the wall or ceiling.
- **Cord guiding** screwed directly on the bracket or with the angle (galvanized and white).
- **Profile guiding** screwed directly into the wall or reveal.

### Option

#### • Coupling

Up to three systems of the same type with an integrated operation.

Total width: max. 6.0m, Total area: max. 16 m<sup>2</sup>,

The fabric weight is depending on the operation variant and the diameter of the shaft  
7.0 kg - 12.0 kg.

### Mounting

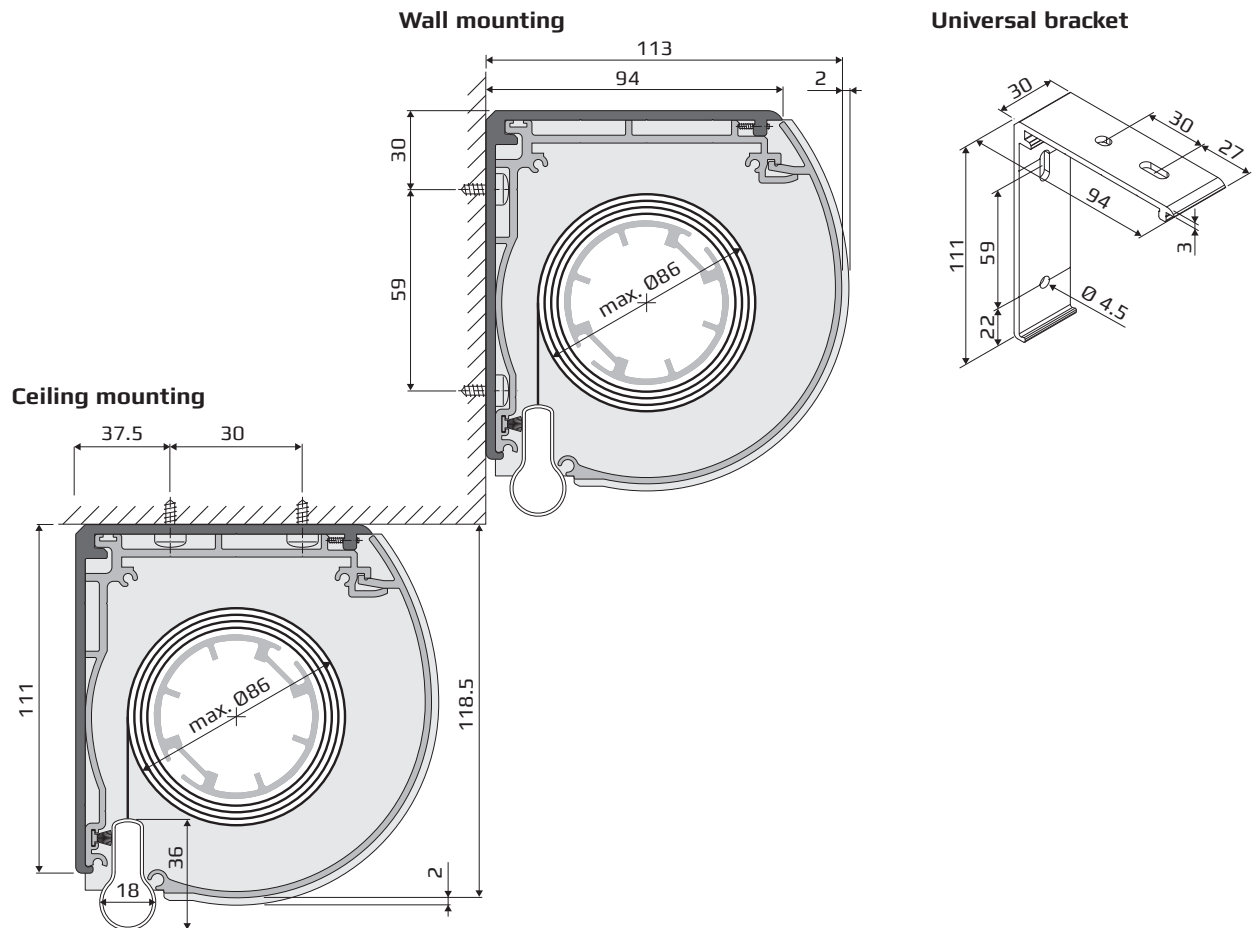

RL21 - Large Roller blind with round cassette profile and lateral chain operation

Cord guiding

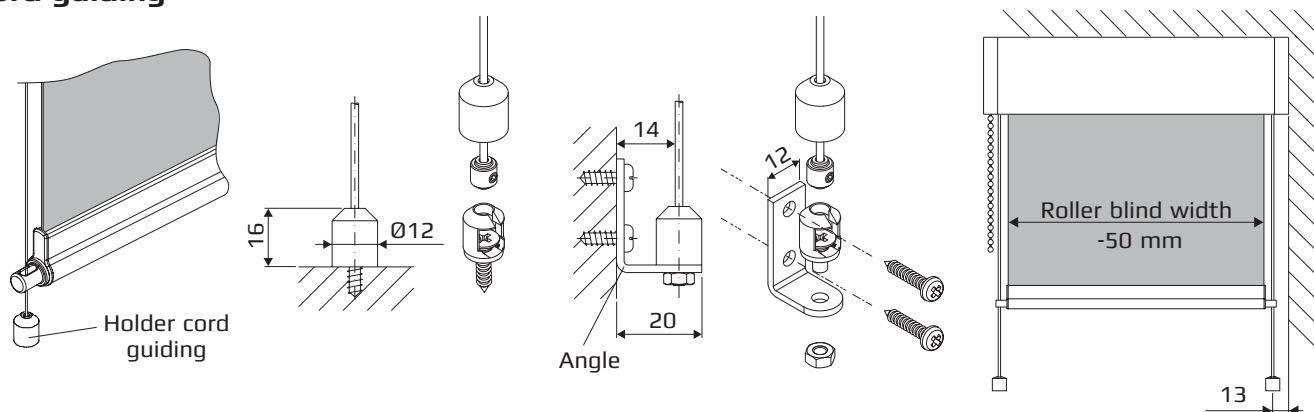

# RL21 - Large Roller blind with round cassette profile and lateral chain operation

## Profile guiding

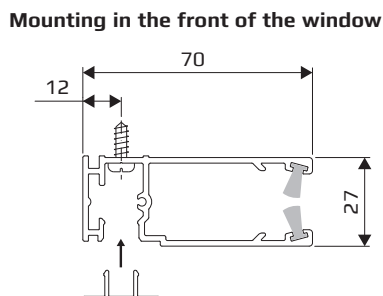
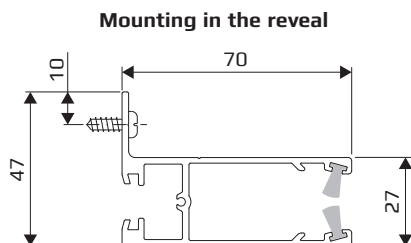

### Moulding for closing profile

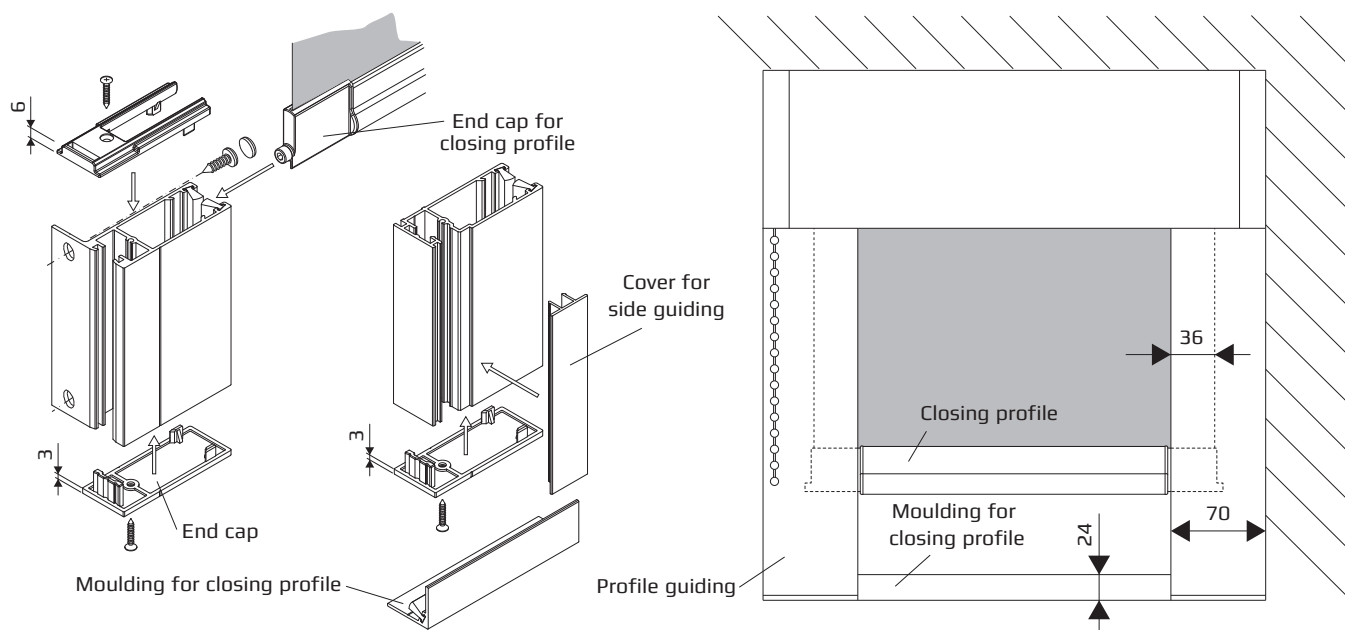
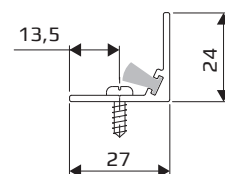

## RL26 - Large Roller blind with round cassette profile and motor operation

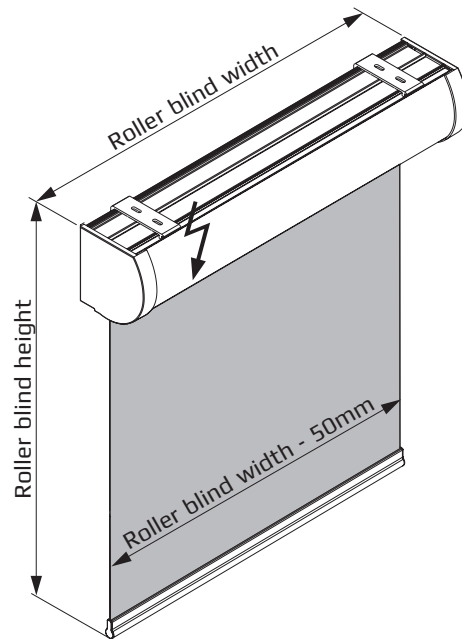

#### Dimensions/ Roller blind measures

- **Width** : max. 4.00 m (depending on the fabric)
- **Height** : max. 4.00 m (depending on the fabric)
- **Fabric** : max. 12.0 kg (depending on the motor)

#### Gear/Hardware

- **Motor drive** in the roller blind shaft.  
The blind can be operated by a switch or remote control to enable an exact, free adjustment of the fabric in any desired position.
- **Cassette profile, round** (115 x 120.5 mm) is made of extruded aluminium (Al Mg Si 0.5 F22).
- **High-precision tube shaft** (Ø43 / Ø52 / Ø65 / Ø75 mm) is made of extruded aluminium (Al Mg Si 0.5 F22).
- **Closing profile** (18 x 36 mm) is made of extruded aluminium (Al Mg Si 0.5 F22) and applicable for the cord guiding, tight brushes are usable.  
Additional weightening by steel profiles is possible.
- **Plastic parts** used are of high-grade, temperatur-resistant and abrasion-resistant material.
- **Cord guiding** at up to a max. 15° angle.  
Steel cord, transparently plastic-coated (Ø2.0 mm).
- **Profile guiding**  
The end caps of the closing profile are guided in the profile guiding.  
The fabric extends on both sides into the profile guiding. Inclination angle: max. 15°.  
Measures: cross section = 70 x 27 (47) mm / length = max. 4.00 m. incl. tight brushes.

#### Operation

- **Plug-in drive SOMFY Sonesse 40 – 230 V**  
suitable for the Ø52 or Ø65 mm tube shaft.  
Protection class: IP 44, rated torque: 3/6 Nm, rated speed: 30/20 rpm, rated voltage: 230 V, rate: 50 Hz, max. power consumption 0.44/0.55 A, rated power: 95/120 W, weight: 1.125/1.25 kg, length: 478/510 mm, connection: 2.5 m cable (3 x 0.75 mm²).
- **Plug-in drive SOMFY Sonesse 40 RTS – 230 V**  
suitable for the Ø52 or Ø65 mm tube shaft.  
Protection class: IP 44, rated torque: 3/6 Nm, rated speed: 30/20 rpm, rated voltage: 230 V, rate: 50 Hz, max. power consumption 0.44/0.55 A, rated power: 95/120 W, weight: 1.225/1.25 kg, length: 517/548 mm, connection: 3.0 m cable (3 x 0.75 mm²).
- **Plug-in drive SOMFY LT 50 Start – 230 V**  
suitable for the Ø65 or Ø75 mm tube shaft.  
Protection class: IP 44, rated torque: 6 Nm, rated speed: 17 rpm, rated voltage: 230 V, rate: 50 Hz, max. power consumption 0.45 A, rated power: 90 W, weight: 1.72 kg, length: 513 mm, connection: 3.0 m cable (4 x 0.75 mm²).
- **Plug-in drive SOMFY 50 RTS Sonesse – 230 V**  
suitable for the Ø65 mm or Ø75 tube shaft.  
Protection class: IP 31, rated torque: 3 Nm, rated speed: 28 rpm, rated voltage: 230 V, rate: 50 Hz, max. power consumption 0.4 A, rated power: 90 W, weight: 2.8 kg, length: 783 mm, connection: 3.0 m cable (4 x 0.75 mm²).
- **Motor side:** optional left or right.

## RL26 - Large Roller blind with round cassette profile and motor operation

### Colours

- **Closing profile** (18 x 36 mm), **Cassette profile** (115 x 120.5 mm) and **Profile guidings** are technically anodised according to E6/EV1 in silver or powder-coated white (RAL 9016), black (RAL 9005), grey (RAL 9006) or beige (RAL 1013).
- **Fixing brackets** are made of galvanized steel.
- Matching **Plastic parts** in white, black, grey and beige.

### Mounting

- **Mounting with universal bracket** on the wall or ceiling.
- **Cord guiding** screwed directly on the bracket or with the angle (galvanized and white).
- **Profile guiding** screwed directly into the wall or reveal.

### Option

#### • Coupling

Up to three systems of the same type with an integrated operation.

Total width: max. 6.0m, Total area: max. 16 m<sup>2</sup>,

The fabric weight is depending on the operation variant and the diameter of the shaft  
7.0 kg - 12.0 kg.

## Mounting

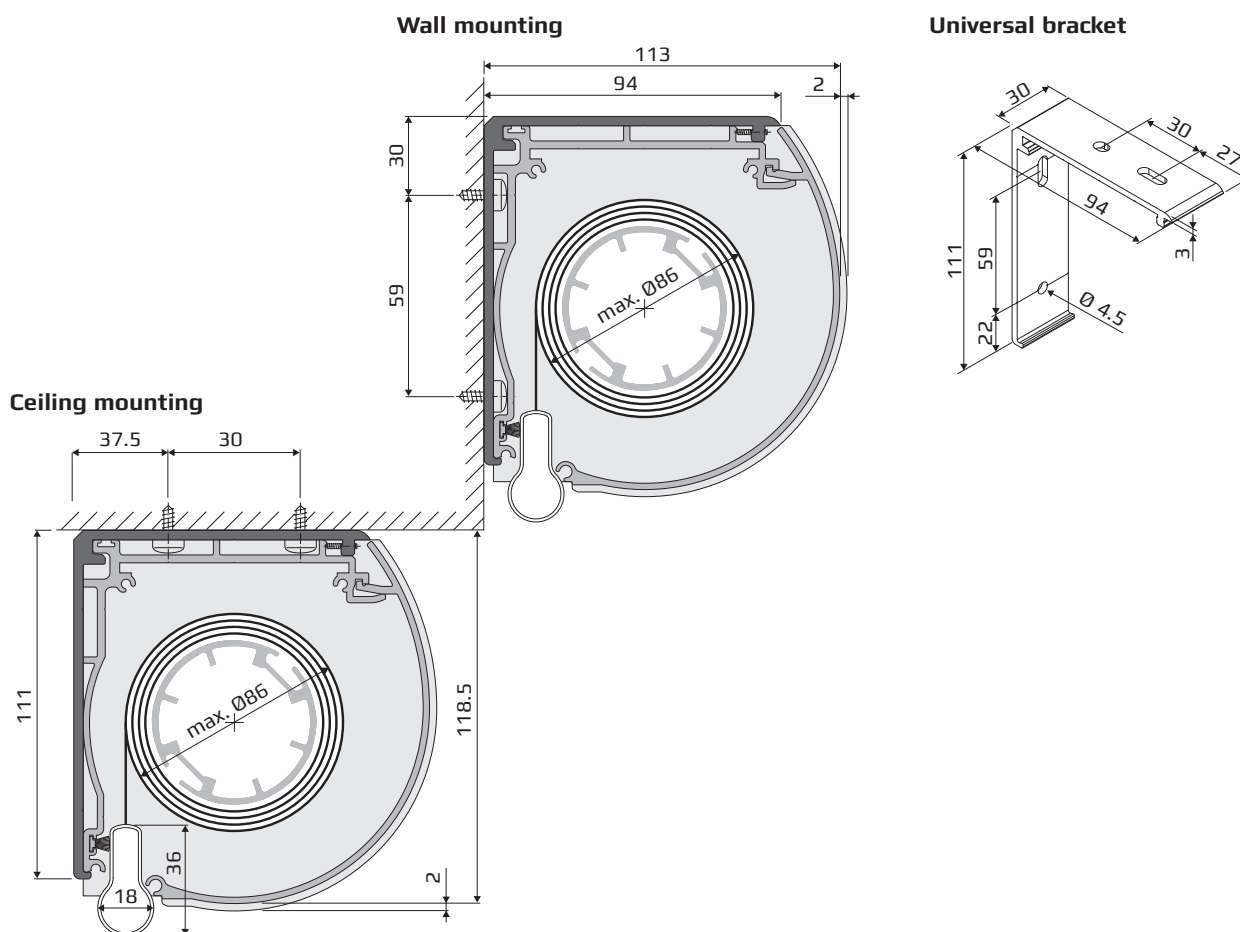

RL26 - Large Roller blind with round cassette profile and motor operation

Cord guiding

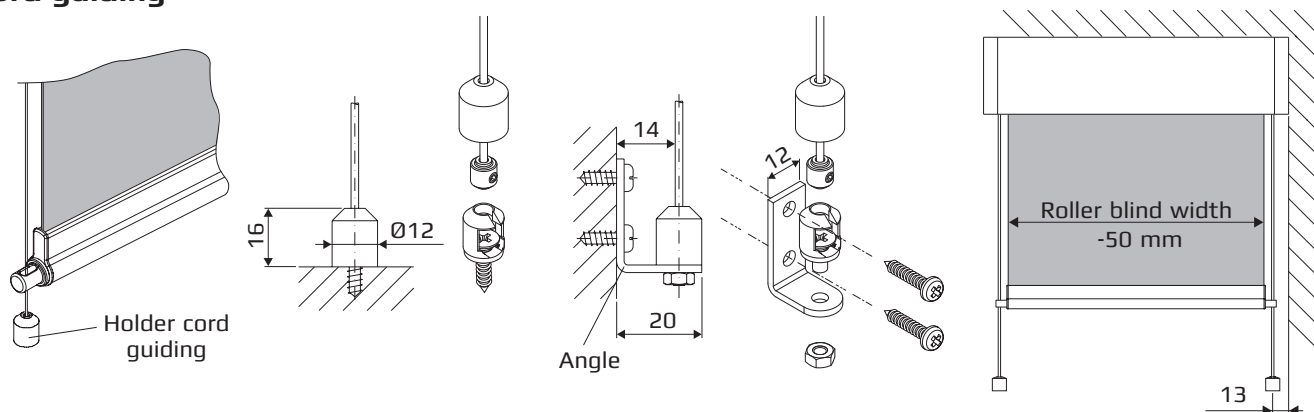



# RL26 - Large Roller blind with round cassette profile and motor operation

## Profile guiding

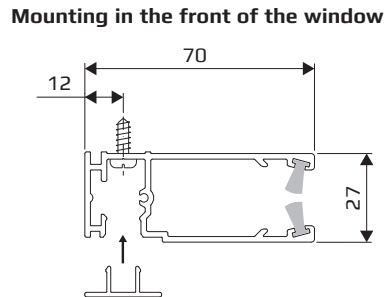
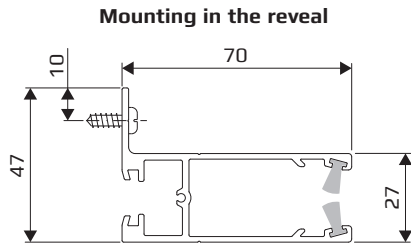

### Moulding for closing profile

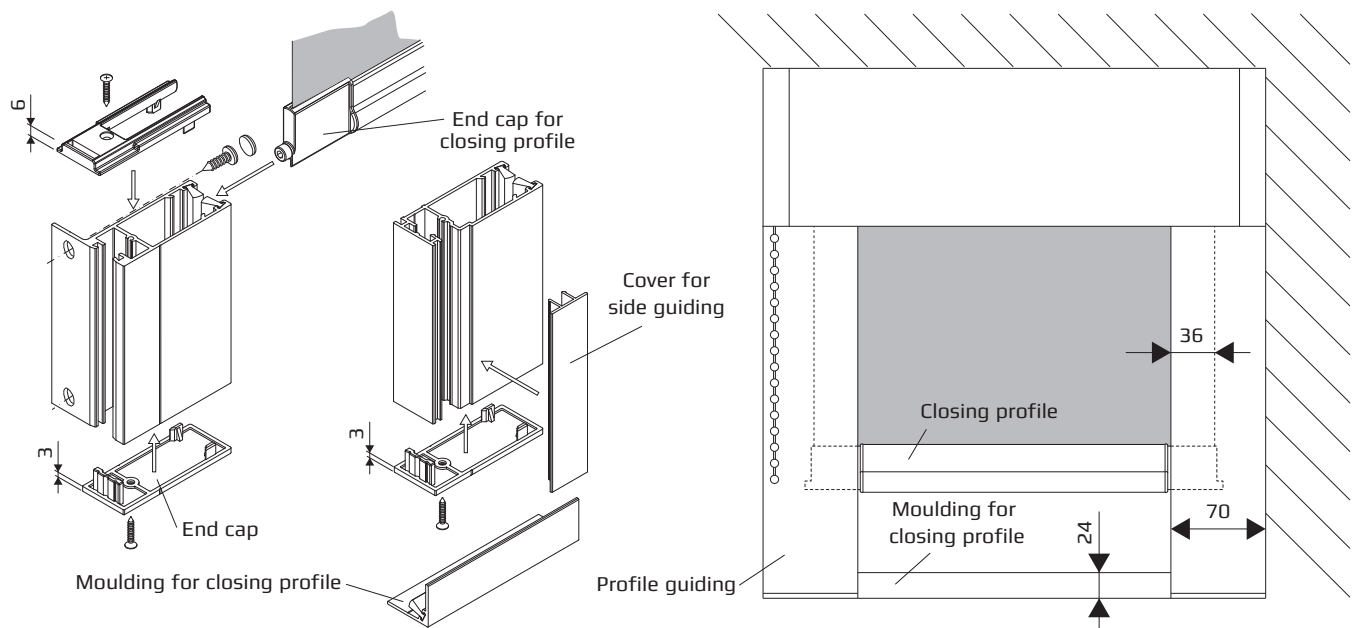
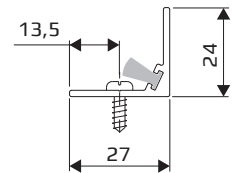

## RL27 - Large Roller blind with round cassette profile and lateral crank operation

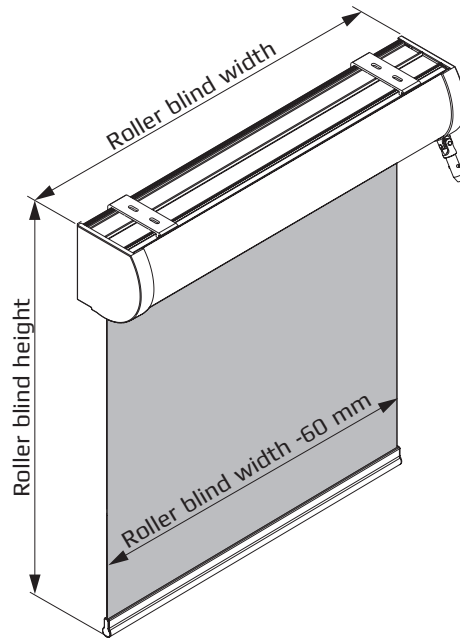

#### Dimensions/ Roller blind measures

- **Width** : max. 4.00 m (depending on the fabric)
- **Height** : max. 4.00 m (depending on the fabric)
- **Fabric** : max. 12.0 kg

#### Gear/Hardware

- **Crank gear box** with an attachable collapsible handle in white or grey.  
The operation is quick, quiet and even. Exact, stepless adjustment of the fabric in any desired position.
- **Cassette profile, round** (115 x 120.5 mm) is made of extruded aluminium (Al Mg Si 0.5 F22).
- **High-precision tube shaft** (Ø43 / Ø52 / Ø65 mm) is made of extruded aluminium (Al Mg Si 0.5 F22).
- **Closing profile** (18 x 36 mm) is made of extruded aluminium (Al Mg Si 0.5 F22) and applicable for the cord guiding, tight brushes are usable.  
Additional weightening by steel profiles is possible.
- **Plastic parts** used are of high-grade, temperatur-resistant and abrasion-resistant material.
- **Cord guiding** at up to a max. 15° angle.  
Steel cord, transparently plastic-coated (Ø2.0 mm).
- **Profile guiding**  
The end caps of the closing profile are guided in the profile guiding.  
The fabric extends on both sides into the profile guiding. Inclination angle: max. 15°.  
Measures: cross section = 70 x 27 (47) mm / length = max. 4.00 m. incl. tight brushes.

#### Operation

- **Crank mechanism with an attachable collapsible handle**  
Gear ratio of 4:1  
Tube shafts Ø43 mm and Ø52 mm: adjustable end position with double end stop and integrated overload protection (depending on the curtain weight).  
Tube shaft Ø65 mm: collapsible handle with overload protection.  
Crank outlet on the wall 30°, on the ceiling 30° forward.  
Collapsible handle, overall length of 1.5 m, 2.0 m or 2.5 m.
- **Operation side:** optional left or right.

#### Colours

- **Closing profile** (18 x 36 mm), **Cassette profile** (115 x 120.5 mm) and **Profile guidings** are technically anodised according to E6/EV1 in silver or powder-coated white (RAL 9016), black (RAL 9005), grey (RAL 9006) or beige (RAL 1013).
- **Fixing brackets** are made of galvanized steel.
- Matching **Plastic parts** in white, black, grey and beige.
- **Collapsible handle:** technically anodised according to E6/EV1 in silver or powder-coated white (RAL 9016), Holder for crank handle in white or grey.

#### Mounting

- **Mounting with universal bracket** on the wall or ceiling.
- **Cord guiding** screwed directly on the bracket or with the angle (galvanized and white).
- **Profilführung** screwed directly into the wall or reveal.

## RL27 - Large Roller blind with round cassette profile and lateral crank operation

### Option

#### • Coupling

Up to three systems of the same type with an integrated operation.

Total width: max. 6.0m, Total area: max. 16 m<sup>2</sup>,

The fabric weight is depending on the operation variant and the diameter of the shaft  
7.0 kg - 12.0 kg.

### Mounting

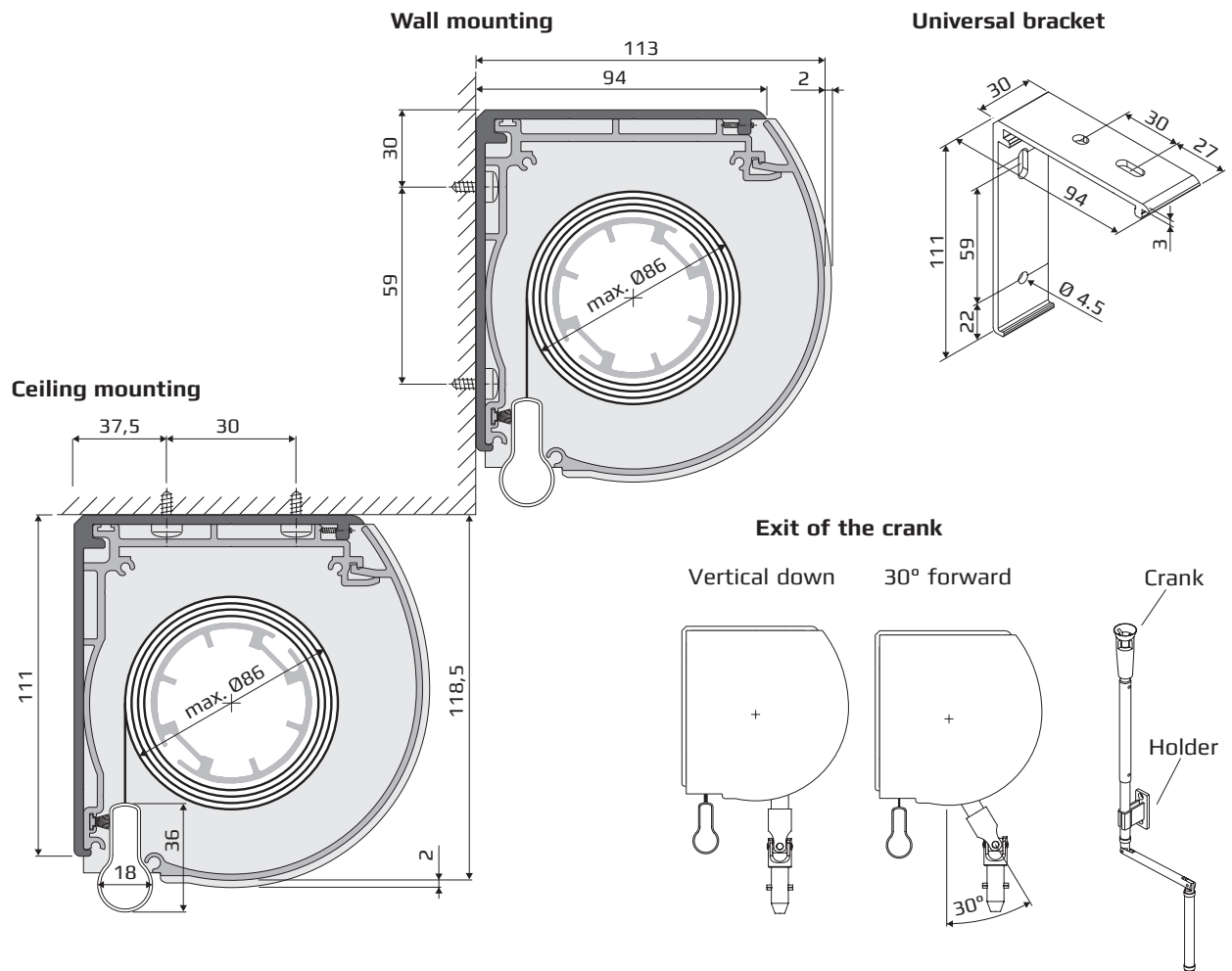

RL27 - Large Roller blind with round cassette profile and lateral crank operation

Cord guiding

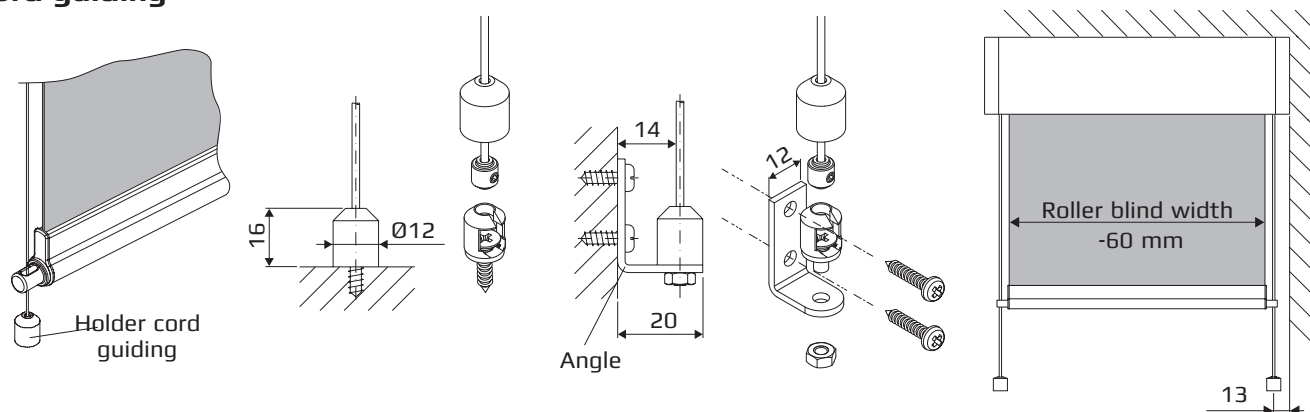

# RL27 - Large Roller blind with round cassette profile and lateral crank operation

## Profile guiding

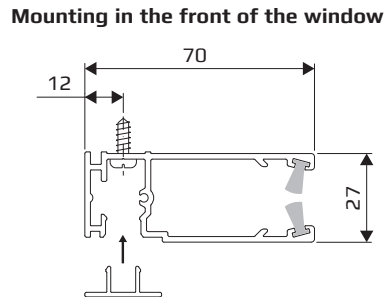
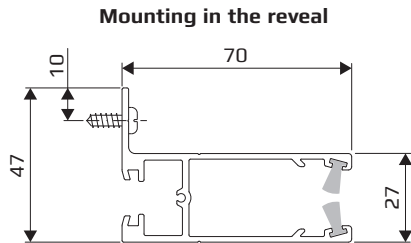

### Moulding for closing profile

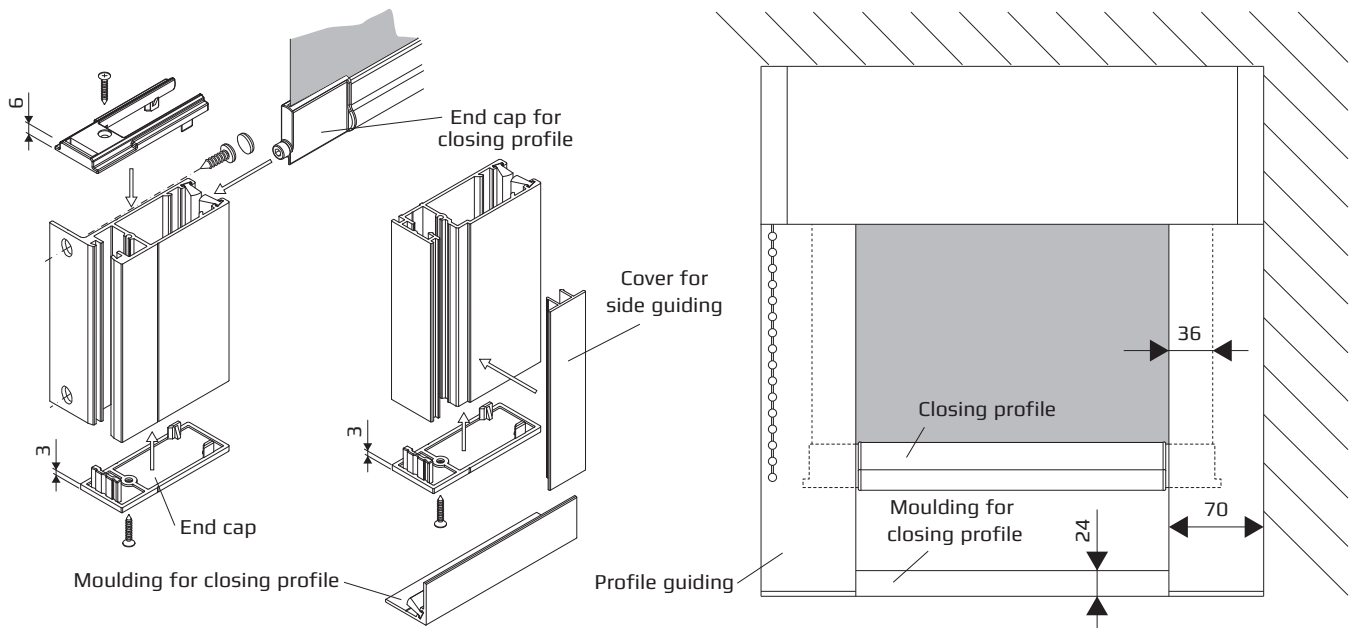
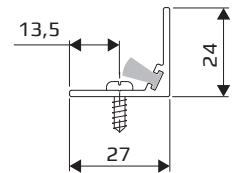

## RL31 - Large Roller blind with angular cassette profile and lateral chain operation

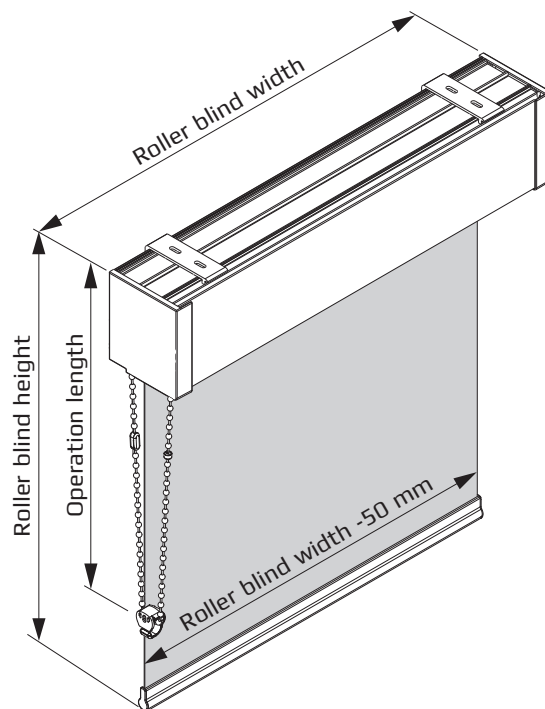

**Child safety:**  
for further informations  
please refer to page 44-45

#### Dimensions/ Roller blind measures

- **Width** : max. 4.00 m (depending on the fabric)
- **Height** : max. 4.00 m (depending on the fabric)
- **Fabric** : max. 12.0 kg

#### Gear/Hardware

- **Side pulley** with a cord lock via spring clutch.  
The spring clutch enables an exact, free positioning of the fabric in any desired position. An additional lift assistance spring enables an easier operation of heavy-weight fabrics.
- **Cassette profile, angular** (104 x 121 mm) is made of extruded aluminium (Al Mg Si 0.5 F22).
- **High-precision tube shaft** (Ø43 / Ø52 / Ø65 mm) is made of extruded aluminium (Al Mg Si 0.5 F22).
- **Closing profile** (18 x 36 mm) is made of extruded aluminium (Al Mg Si 0.5 F22) and applicable for the cord guiding, tight brushes are usable.  
Additional weighting by steel profiles is possible.
- **Plastic parts** used are of high-grade, temperatur-resistant and abrasion-resistant material.
- **Cord guiding** at up to a max. 15° angle.  
Steel cord, transparently plastic-coated (Ø2.0 mm).
- **Profile guiding**  
The end caps of the closing profile are guided in the profile guiding.  
The fabric extends on both sides into the profile guiding. Inclination angle: max. 15°.  
Measures: cross section = 70 x 27 (47) mm / length = max. 4.00 m. incl. tight brushes.

#### Operation

- **Chain operation**  
by an **endless ball chain** (Ø6.0 mm x 12.0 mm) - plastic balls on a polyester cord in transparent/white, transparent/grey or transparent/black.  
Optional **metal ball chain** (Ø4.5 x 6.0 mm) made of nickel-plated brass or stainless steel or plastic ball chain (Ø4.5 x 6.0 mm) in white, black, grey and beige.
- **Final position limitation** through chain stopper in transparent.
- **Operation side:** optional left or right.
- **Fixation** of the chain operation by through Cord/chain safety device transparent.  
or the use of a chain securing device (no final position limitation through chain stopper).
- **Operation length:** freely selectable (In compliance with child safety).

#### Colours

- **Closing profile** (18 x 36 mm), **Cassette profile** (104 x 121 mm) and **Profile guidings** are technically anodised according to E6/EV1 in silver or powder-coated white (RAL 9016), black (RAL 9005), grey (RAL 9006) or beige (RAL 1013).
- **Fixing brackets** are made of galvanized steel.
- Matching **Plastic parts** in white, black, grey and beige.

**RL31 - Large Roller blind with angular cassette profile and lateral chain operation****Mounting**

- **Mounting with universal bracket** on the wall or ceiling.
- **Cord guiding** screwed directly on the bracket or with the angle (galvanized and white).
- **Profile guiding** screwed directly on the wall or ceiling.

**Option**

- **Coupling**

Up to three systems of the same type with an integrated operation.

Total width: max. 6.0m, Total area: max. 16 m<sup>2</sup>,

The fabric weight is depending on the operation variant and the diameter of the shaft  
7.0 kg - 12.0 kg.

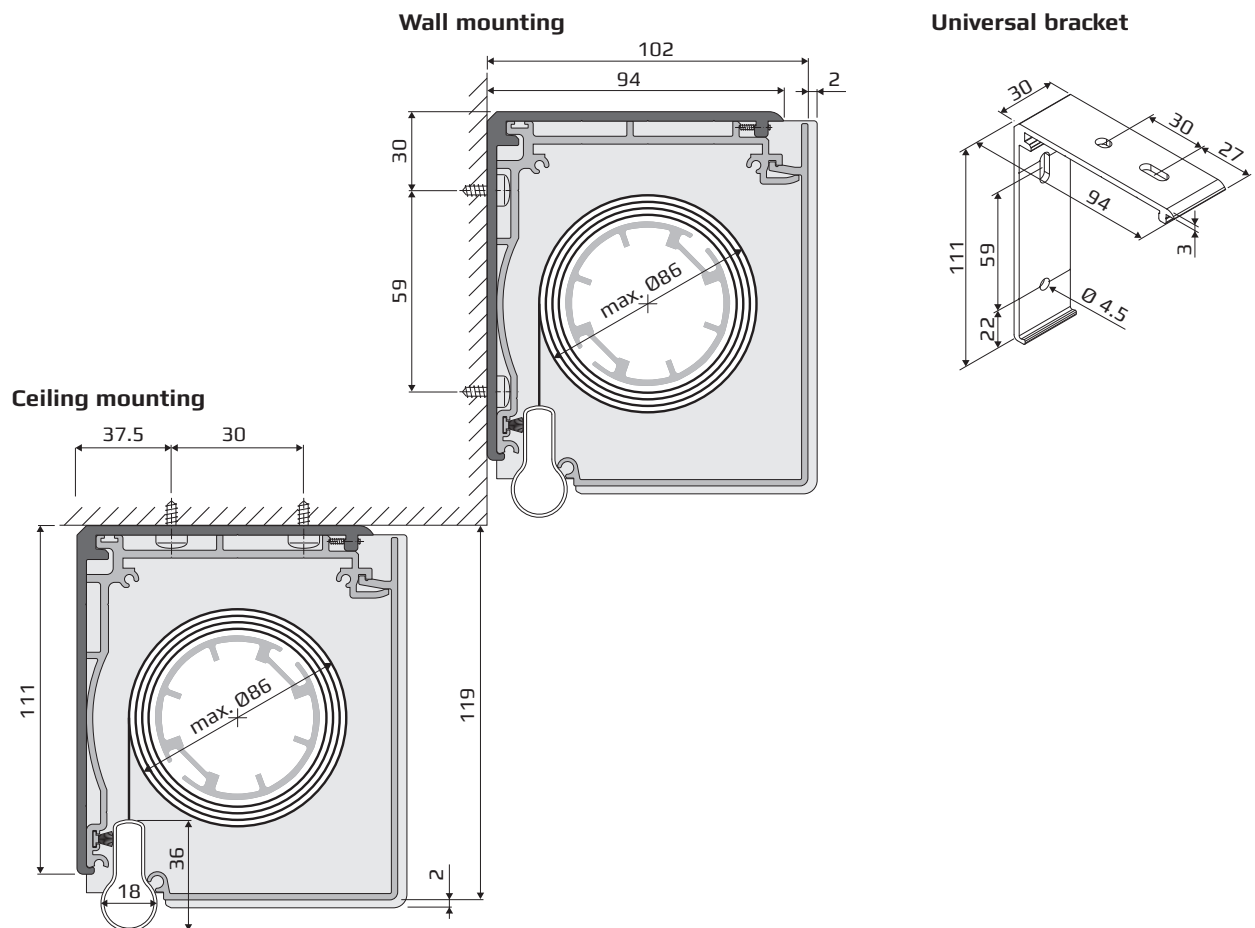
**Mounting**



RL31 - Large Roller blind with angular cassette profile and lateral chain operation

Cord guiding

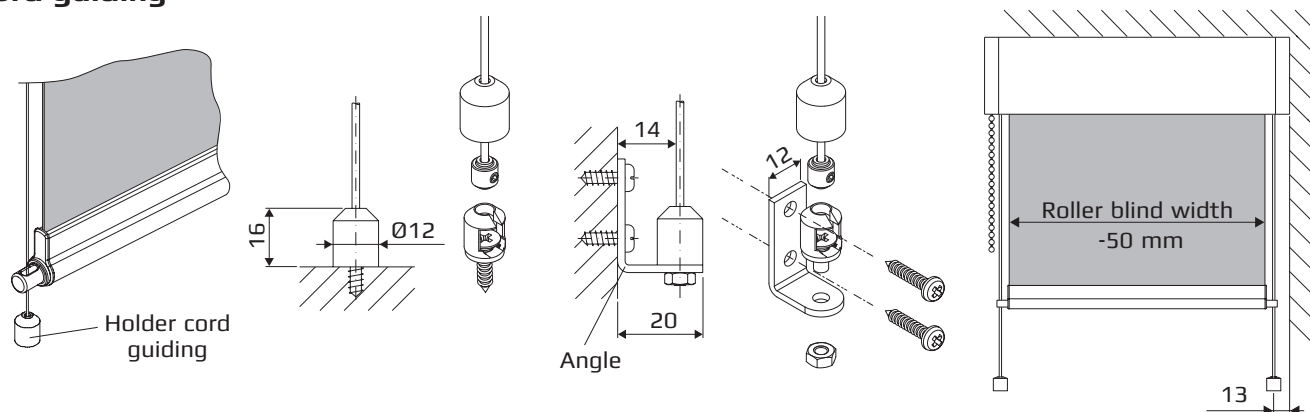

# RL31 - Large Roller blind with angular cassette profile and lateral chain operation

## Profile guiding

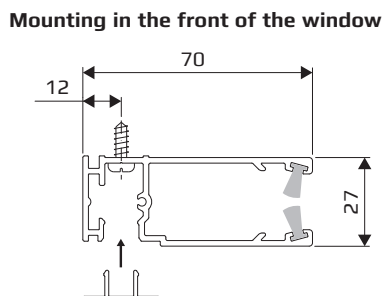
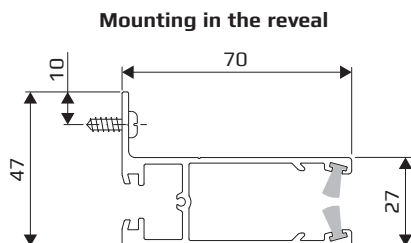

### Moulding for closing profile

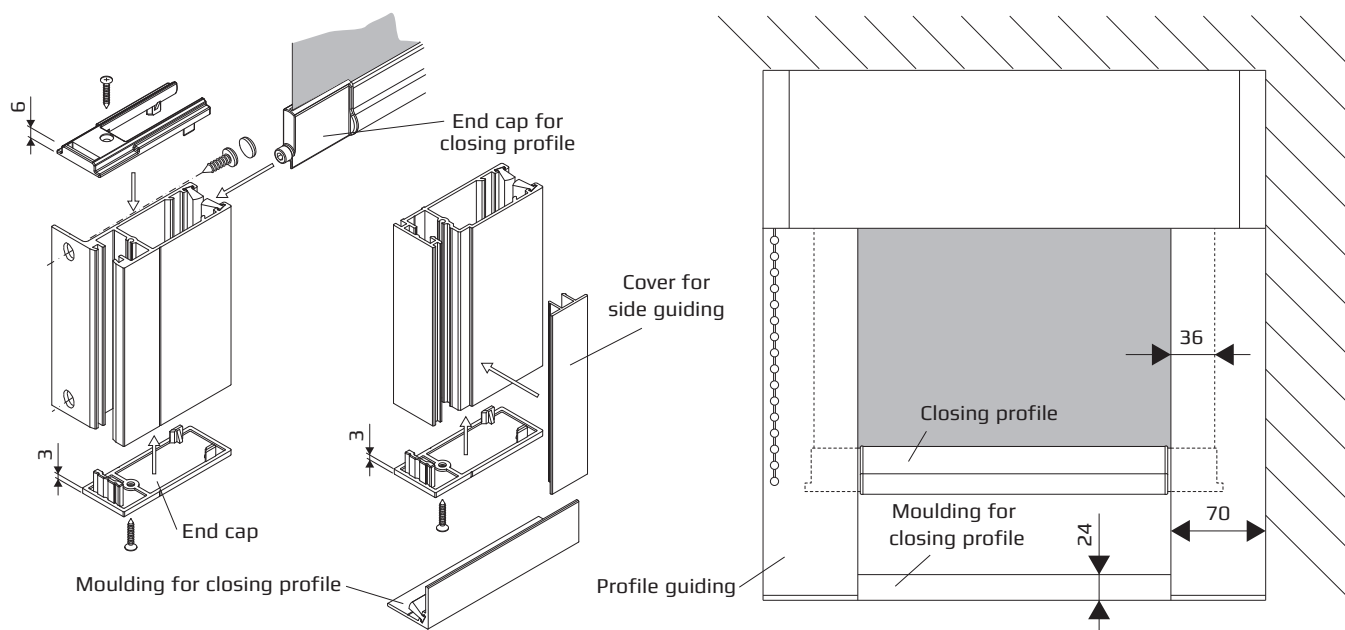
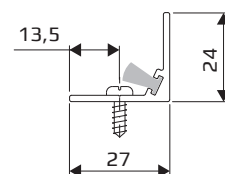

## RL36 - Large Roller blind with angular cassette profile and motor operation

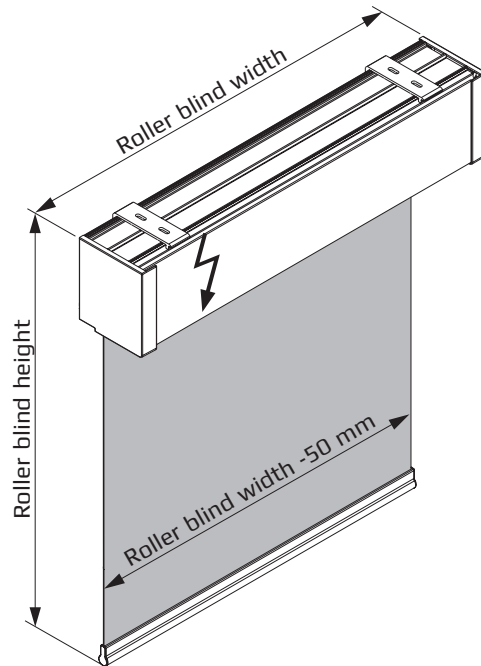

#### Dimensions/ Roller blind measures

- **Width** : max. 4.00 m (depending on the fabric)
- **Height** : max. 4.00 m (depending on the fabric)
- **Fabric** : max. 12.0 kg (depending on the motor)

#### Gear/Hardware

- **Motor drive** in the roller blind shaft.  
The blind can be operated by a switch or remote control to enable an exact, free adjustment of the fabric in any desired position.
- **Cassette profile, angular** (104 x 121 mm) is made of extruded aluminium (Al Mg Si 0.5 F22).
- **High-precision tube shaft** (Ø43 / Ø52 / Ø65 / Ø75 mm) is made of extruded aluminium (Al Mg Si 0.5 F22).
- **Closing profile** (18 x 36 mm) is made of extruded aluminium (Al Mg Si 0.5 F22) and applicable for the cord guiding, tight brushes are usable.  
Additional weightening by steel profiles is possible.
- **Plastic parts** used are of high-grade, temperatur-resistant and abrasion-resistant material.
- **Cord guiding** at up to a max. 15° angle.  
Steel cord, transparently plastic-coated (Ø2.0 mm).
- **Profile guiding**  
The end caps of the closing profile are guided in the profile guiding.  
The fabric extends on both sides into the profile guiding. Inclination angle: max. 15°.  
Measures: cross section = 70 x 27 (47) mm / length = max. 4.00 m. incl. tight brushes.

#### Operation

- **Plug-in drive SOMFY Sonesse 40 – 230 V**  
suitable for the Ø52 or Ø65 mm tube shaft.  
Protection class: IP 44, rated torque: 3/6 Nm, rated speed: 30/20 rpm,  
rated voltage: 230 V, rate: 50 Hz, max. power consumption 0.44/0.55 A,  
rated power: 95/120 W, weight: 1.125/1.25 kg, length: 478/510 mm,  
connection: 2.5 m cable (3 x 0.75 mm²).
- **Plug-in drive SOMFY Sonesse 40 RTS – 230 V**  
suitable for the Ø52 or Ø65 mm tube shaft.  
Protection class: IP 44, rated torque: 3/6 Nm, rated speed: 30/20 rpm,  
rated voltage: 230 V, rate: 50 Hz, max. power consumption 0.44/0.55 A,  
rated power: 95/120 W, weight: 1.225/1.25 kg, length: 517/548 mm,  
connection: 3.0 m cable (3 x 0.75 mm²).
- **Plug-in drive SOMFY LT 50 Start – 230 V**  
suitable for the Ø65 or Ø75 mm tube shaft.  
Protection class: IP 44, rated torque: 6 Nm, rated speed: 17 rpm, rated voltage: 230 V,  
rate: 50 Hz, max. power consumption 0.45 A, rated power: 90 W, weight: 1.72 kg,  
length: 513 mm, connection: 3.0 m cable (4 x 0.75 mm²).

## RL36 - Large Roller blind with angular cassette profile and motor operation

- **Plug-in drive SOMFY 50 RTS Sonesse – 230V**  
suitable for the Ø65 or Ø75 mm tube shaft.  
Protection class: IP 31, rated torque: 3 Nm, rated speed: 28 rpm, rated voltage: 230 V, rate: 50 Hz, max. power consumption 0.4 A, rated power: 90 W, weight: 2.8 kg, length: 783 mm, connection: 3.0 m cable (4 x 0.75 mm²).

- **Motor side:** optional left or right.

### Colours

- **Closing profile** (18 x 36 mm), **Cassette profile** (104 x 121 mm) and **Profile guidings** are technically anodised according to E6/EV1 in silver or powder-coated white (RAL 9016), black (RAL 9005), grey (RAL 9006) or beige (RAL 1013).
- **Fixing brackets** are made of galvanized steel.
- Matching **Plastic parts** in white, black, grey and beige.

### Mounting

- **Mounting with universal bracket** on the wall or ceiling.
- **Cord guiding** screwed directly on the bracket or with the angle (galvanized and white).
- **Profile guiding** screwed directly into the wall or reveal.

### Option

- **Coupling**  
Up to three systems of the same type with an integrated operation.  
Total width: max. 6.0m, Total area: max. 16 m²,  
The fabric weight is depending on the operation variant and the diameter of the shaft  
7.0 kg - 12.0 kg.

## Mounting

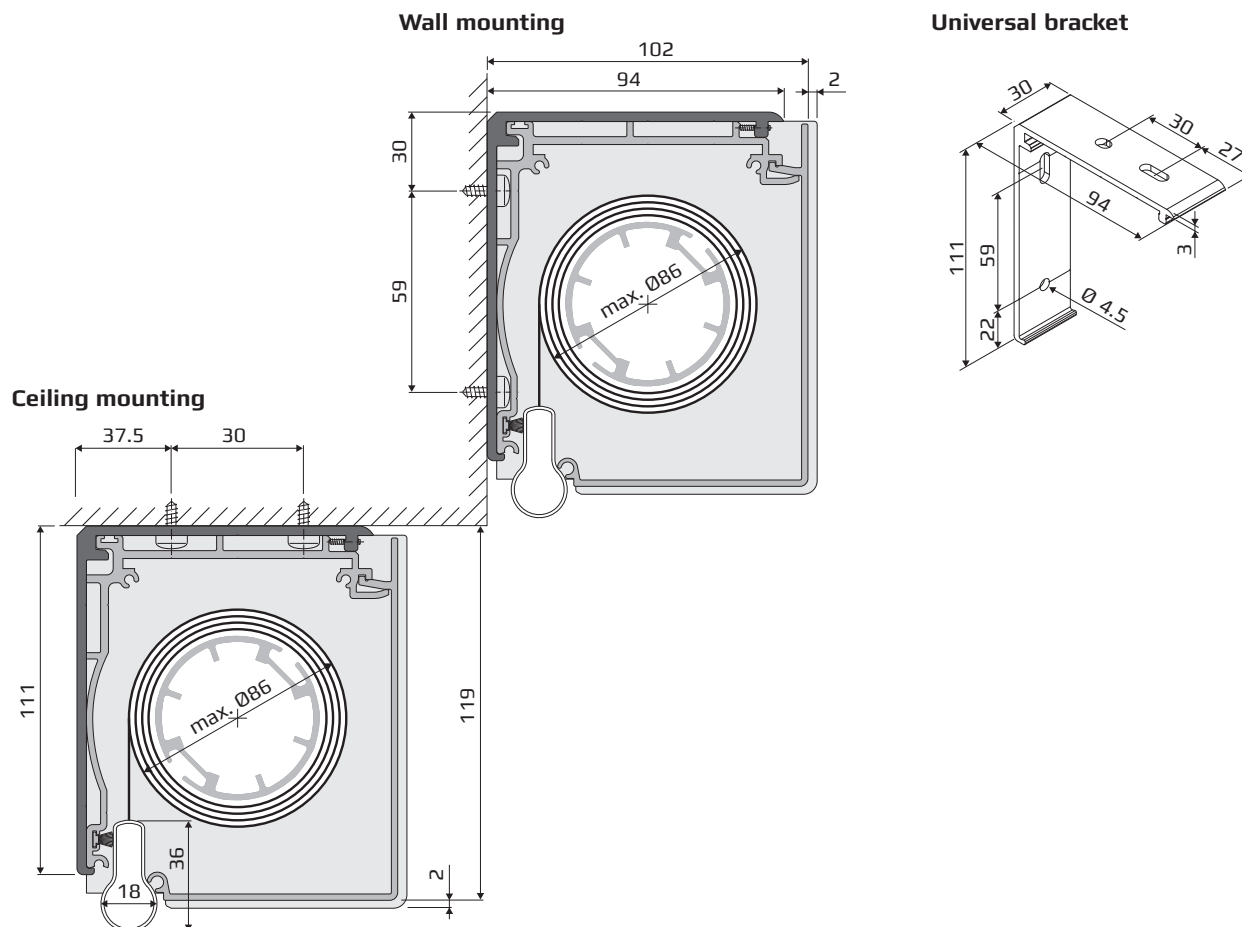

RL36 - Large Roller blind with angular cassette profile and motor operation

Cord guiding

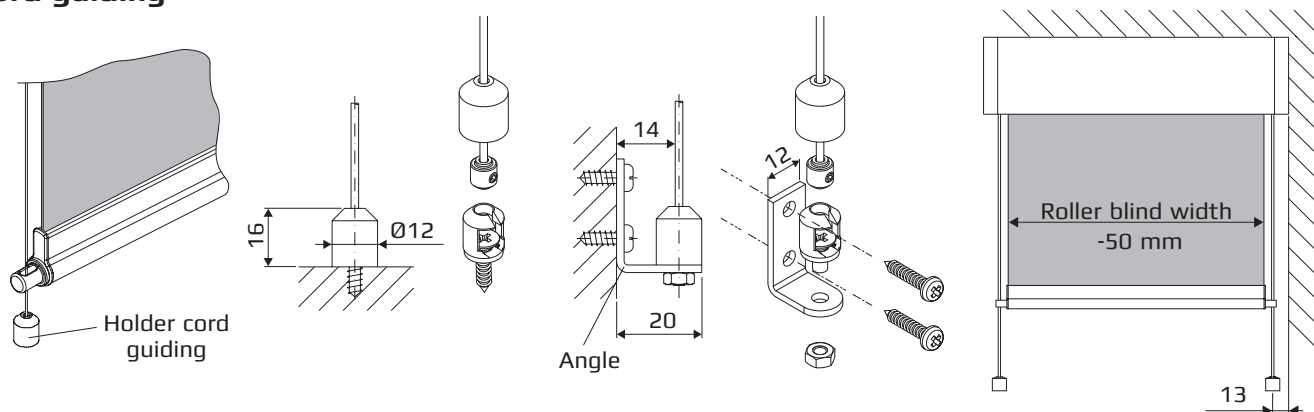

## RL36 - Large Roller blind with angular cassette profile and motor operation

## Profile guiding

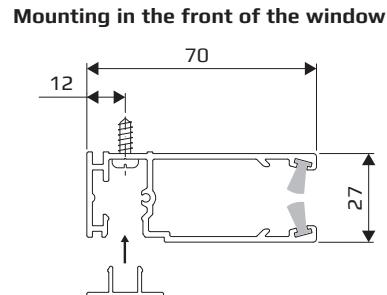
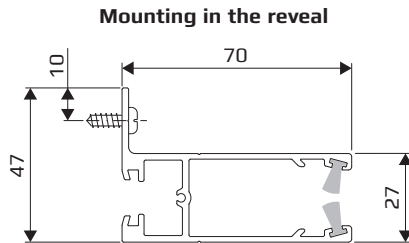
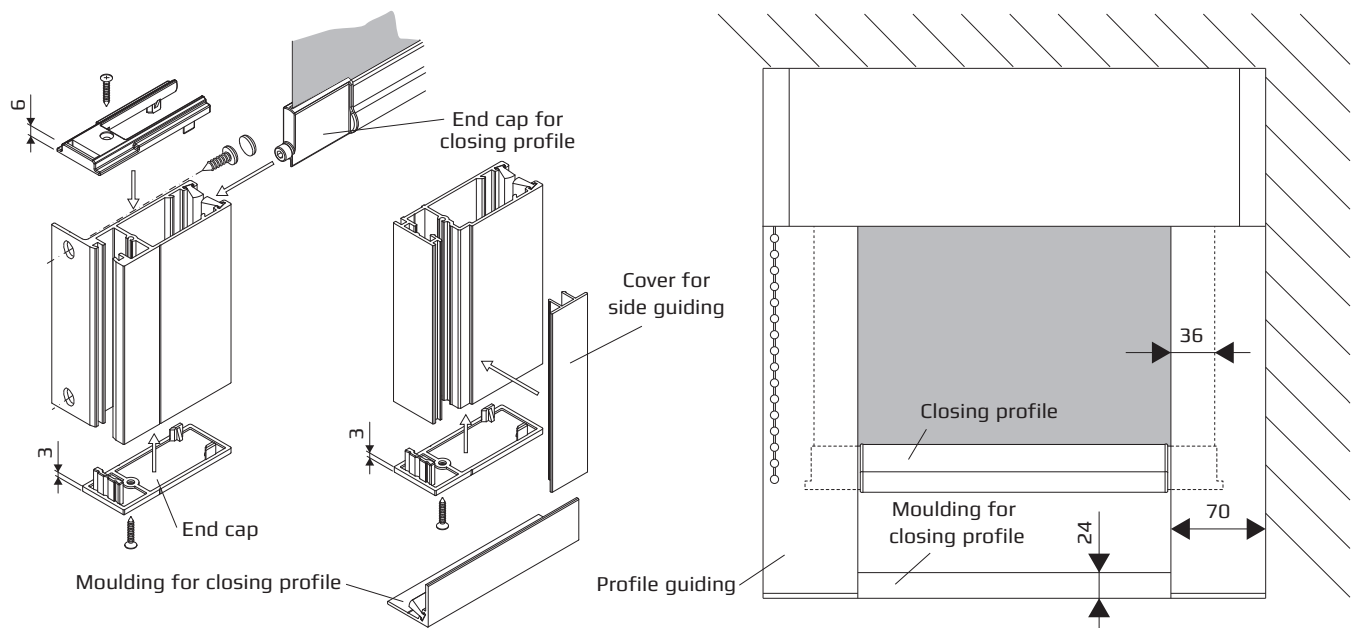
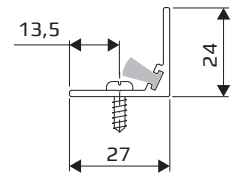
**Moulding for closing profile**

## RL37 - Large Roller blind with angular cassette profile and lateral crank operation

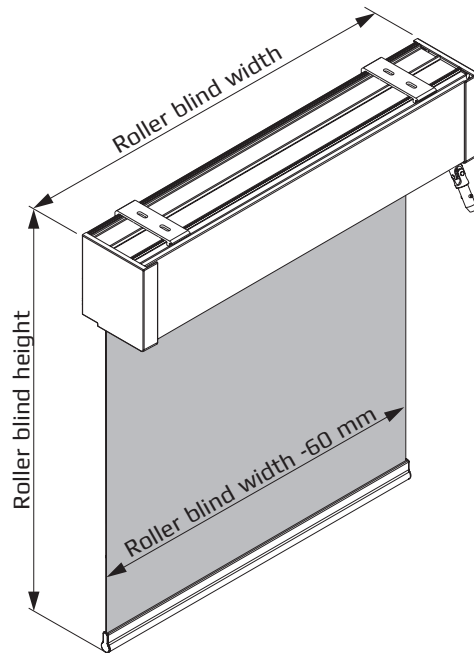

#### Dimensions/ Roller blind measures

- **Width** : max. 4.00 m (depending on the fabric)
- **Height** : max. 4.00 m (depending on the fabric)
- **Fabric** : max. 12.0 kg

#### Gear/Hardware

- **Crank gear box** with an attachable collapsible handle in white or grey.  
The operation is quick, quiet and even. Exact, stepless adjustment of the fabric in any desired position.
- **Cassette profile, angular** (104 x 121 mm) is made of extruded aluminium (Al Mg Si 0.5 F22).
- **High-precision tube shaft** (Ø43 / Ø52 / Ø65 mm) is made of extruded aluminium (Al Mg Si 0.5 F22).
- **Closing profile** (18 x 36 mm) is made of extruded aluminium (Al Mg Si 0.5 F22) and applicable for the cord guiding, tight brushes are usable.  
Additional weighting by steel profiles is possible.
- **Plastic parts** used are of high-grade, temperatur-resistant and abrasion-resistant material.
- **Cord guiding** at up to a max. 15° angle.  
Steel cord, transparently plastic-coated (Ø2.0 mm).
- **Profile guiding**  
The end caps of the closing profile are guided in the profile guiding.  
The fabric extends on both sides into the profile guiding. Inclination angle: max. 15°.  
Measures: cross section = 70 x 27 (47) mm / length = max. 4.00 m. incl. tight brushes.

#### Operation

- **Crank mechanism with an attachable collapsible handle**  
Gear ratio of 4:1  
Tube shafts Ø43 mm and Ø52 mm: adjustable end position with double end stop and integrated overload protection (depending on the curtain weight).  
Tube shaft Ø65 mm: collapsible handle with overload protection.  
Crank outlet on the wall 30°, on the ceiling 30° forward.  
Collapsible handle, overall length of 1.5 m, 2.0 m or 2.5 m.
- **Operation side:** optional left or right.

#### Colours

- **Closing profile** (18 x 36 mm), **Cassette profile** (104 x 121 mm) and **Profile guidings** are technically anodised according to E6/EV1 in silver or powder-coated white (RAL 9016), black (RAL 9005), grey (RAL 9006) or beige (RAL 1013).
- **Fixing brackets** are made of galvanized steel.
- Matching **Plastic parts** in white, black, grey and beige.
- **Collapsible handle:** technically anodised according to E6/EV1 in silver or powder-coated white (RAL 9016), Holder for crank handle in white or grey.

#### Mounting

- **Mounting with universal bracket** on the wall or ceiling.
- **Cord guiding** screwed directly on the bracket or with the angle (galvanized and white).
- **Profile guiding** screwed directly into the wall or reveal.



**RL37 - Large Roller blind with angular cassette profile and lateral crank operation****Option****• Coupling**

Up to three systems of the same type with an integrated operation.

Total width: max. 6.0m, Total area: max. 16 m<sup>2</sup>,

The fabric weight is depending on the operation variant and the diameter of the shaft  
7.0 kg - 12.0 kg.

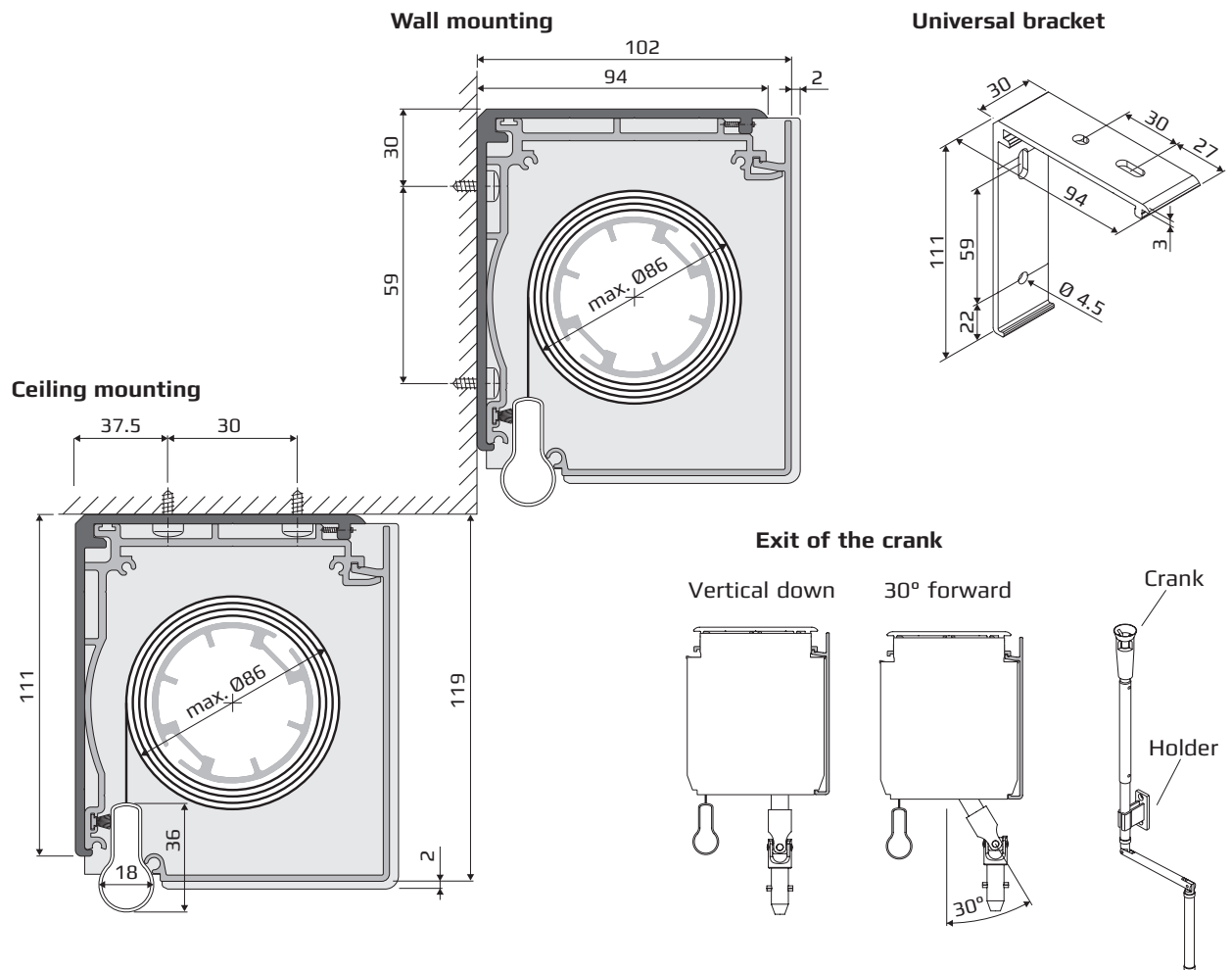
**Mounting**

RL37 - Large Roller blind with angular cassette profile and lateral crank operation

Cord guiding

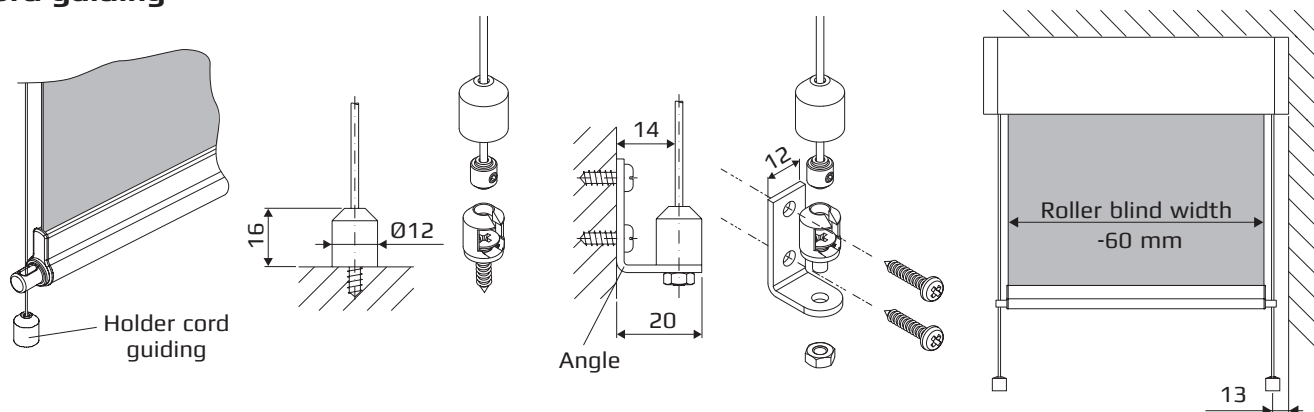

# RL37 - Large Roller blind with angular cassette profile and lateral crank operation

## Profile guiding

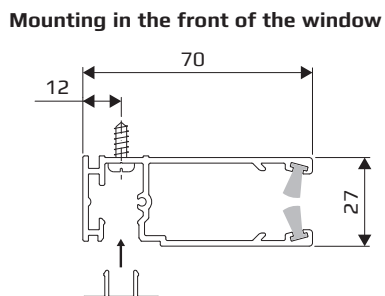
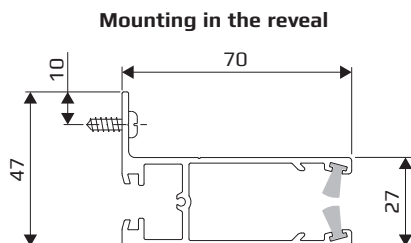

## Moulding for closing profile

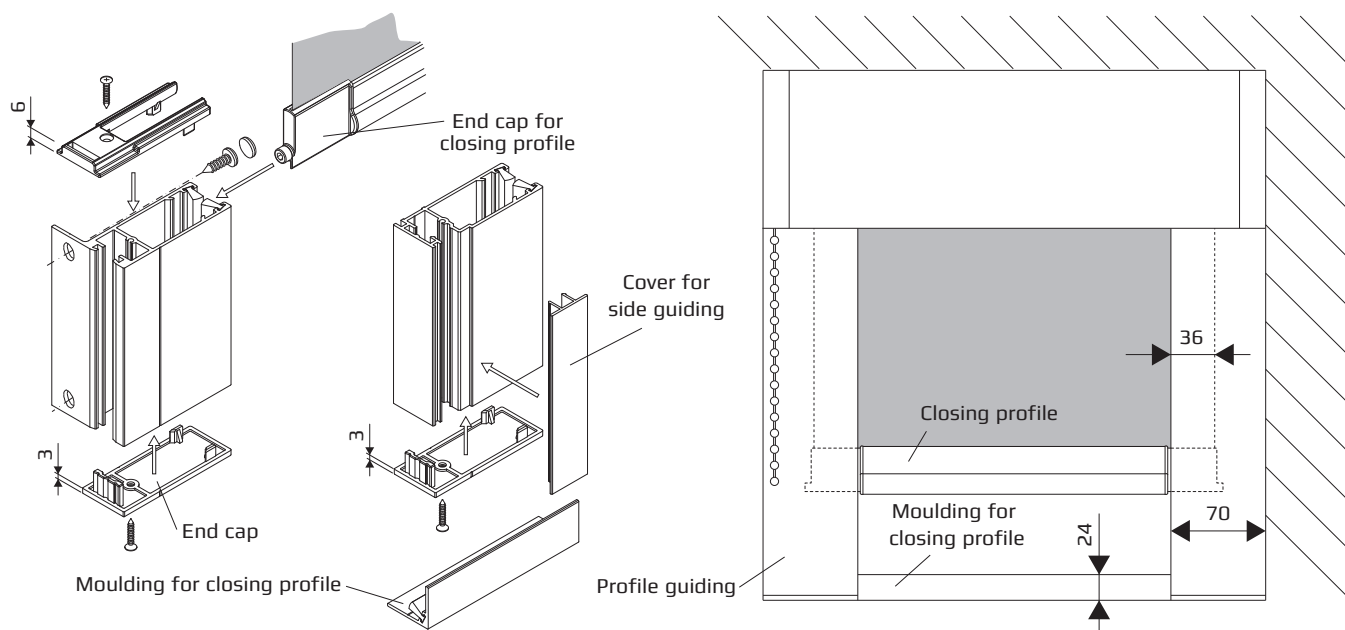
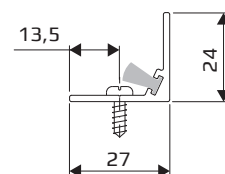

RL01 - Large Roller blind with mounting bracket and lateral chain operation

RL06 - Large Roller blind with mounting bracket and motor operation

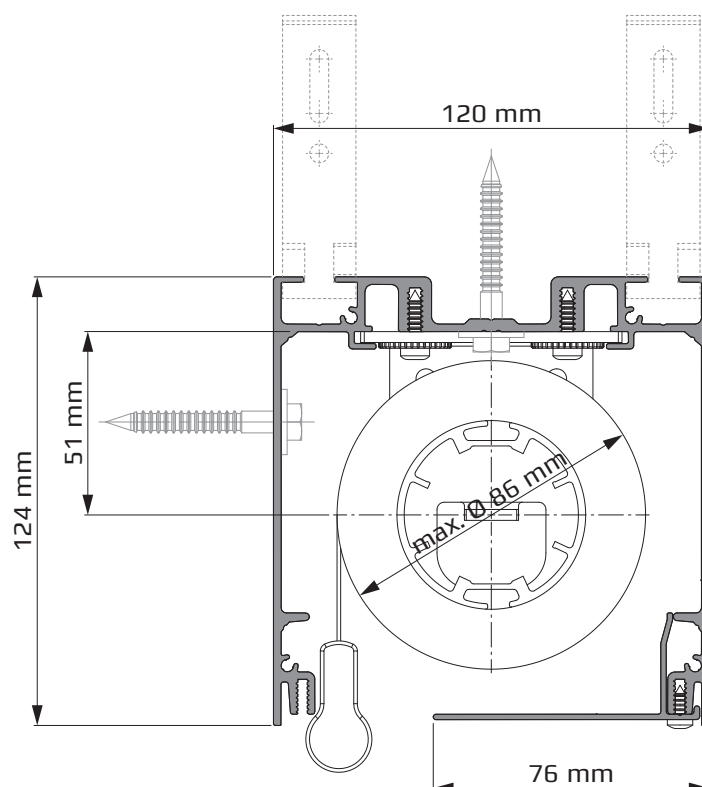
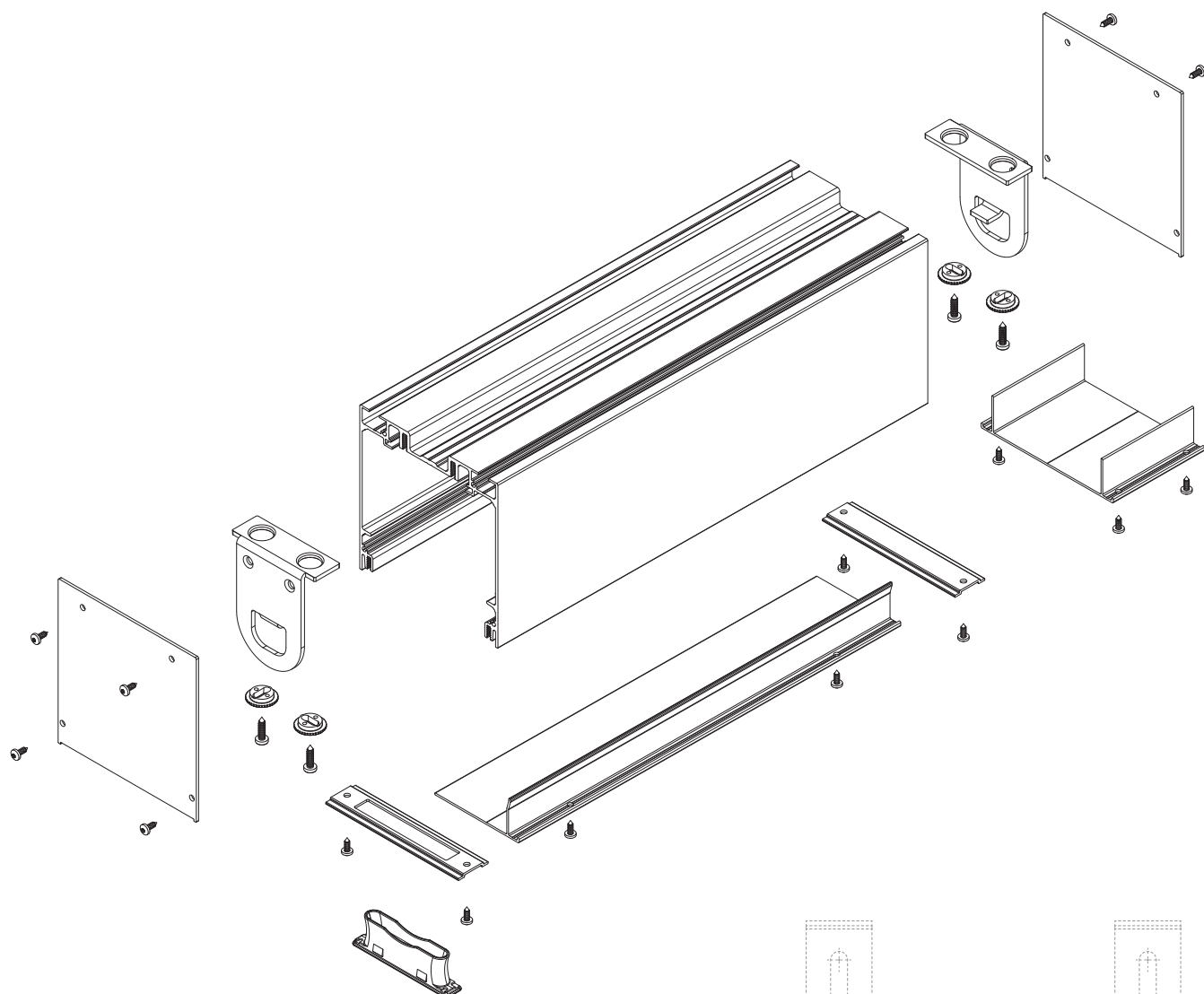

RL01 - Large Roller blind with mounting bracket and lateral chain operation

RL06 - Large Roller blind with mounting bracket and motor operation

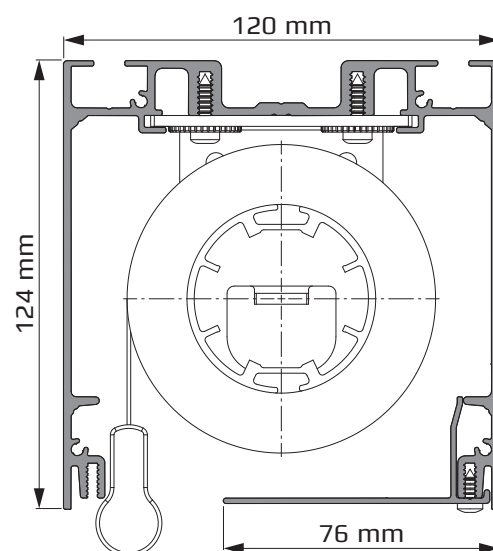
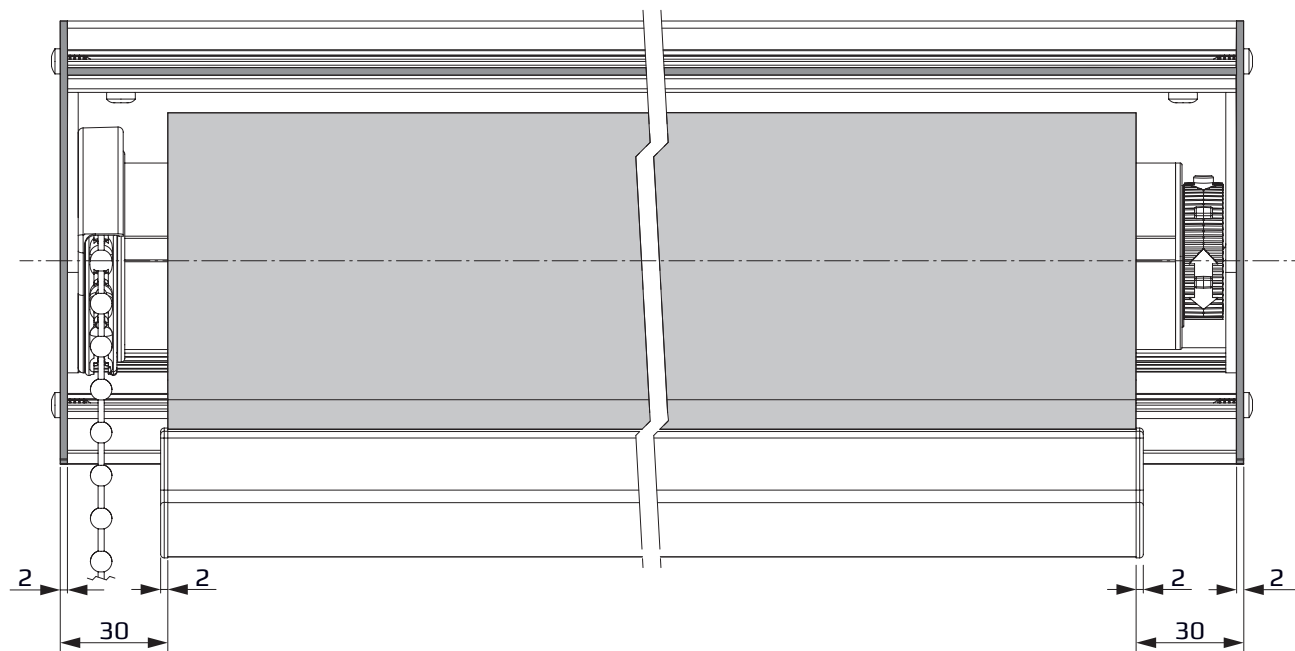

- RL01 - Large Roller blind with mounting bracket and lateral chain operation
- RL06 - Large Roller blind with mounting bracket and motor operation

## Ceiling mounting

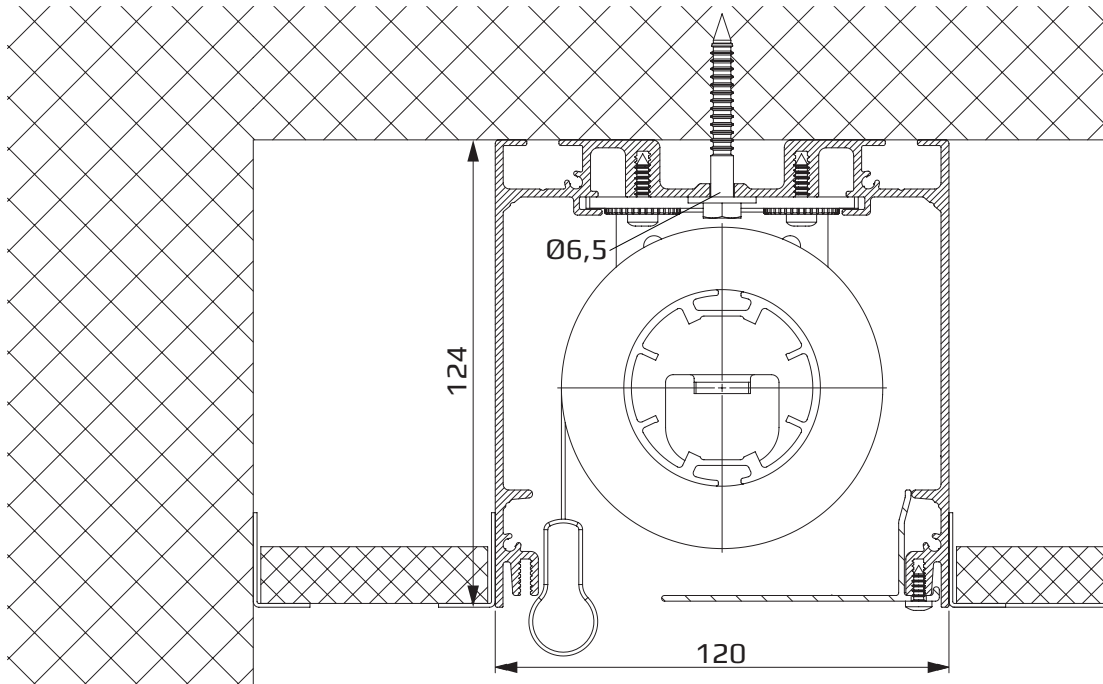

## Wall mounting

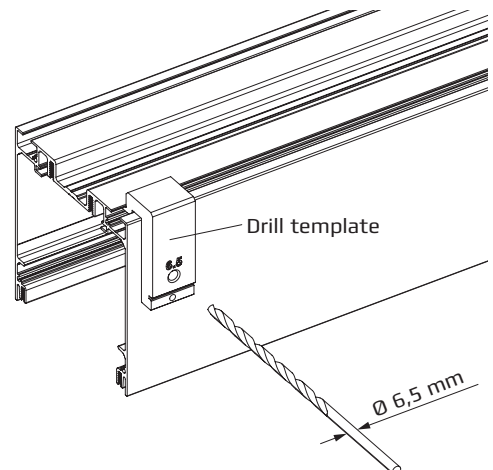
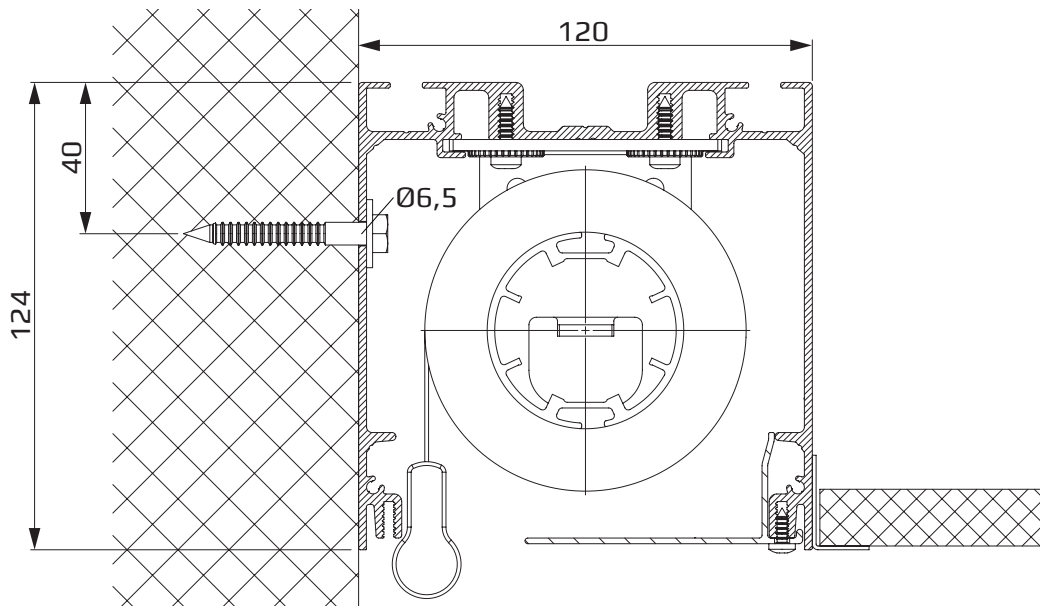

RL01 - Large Roller blind with mounting bracket and lateral chain operation

RL06 - Large Roller blind with mounting bracket and motor operation

### Ceiling mounting (suspended ceiling)

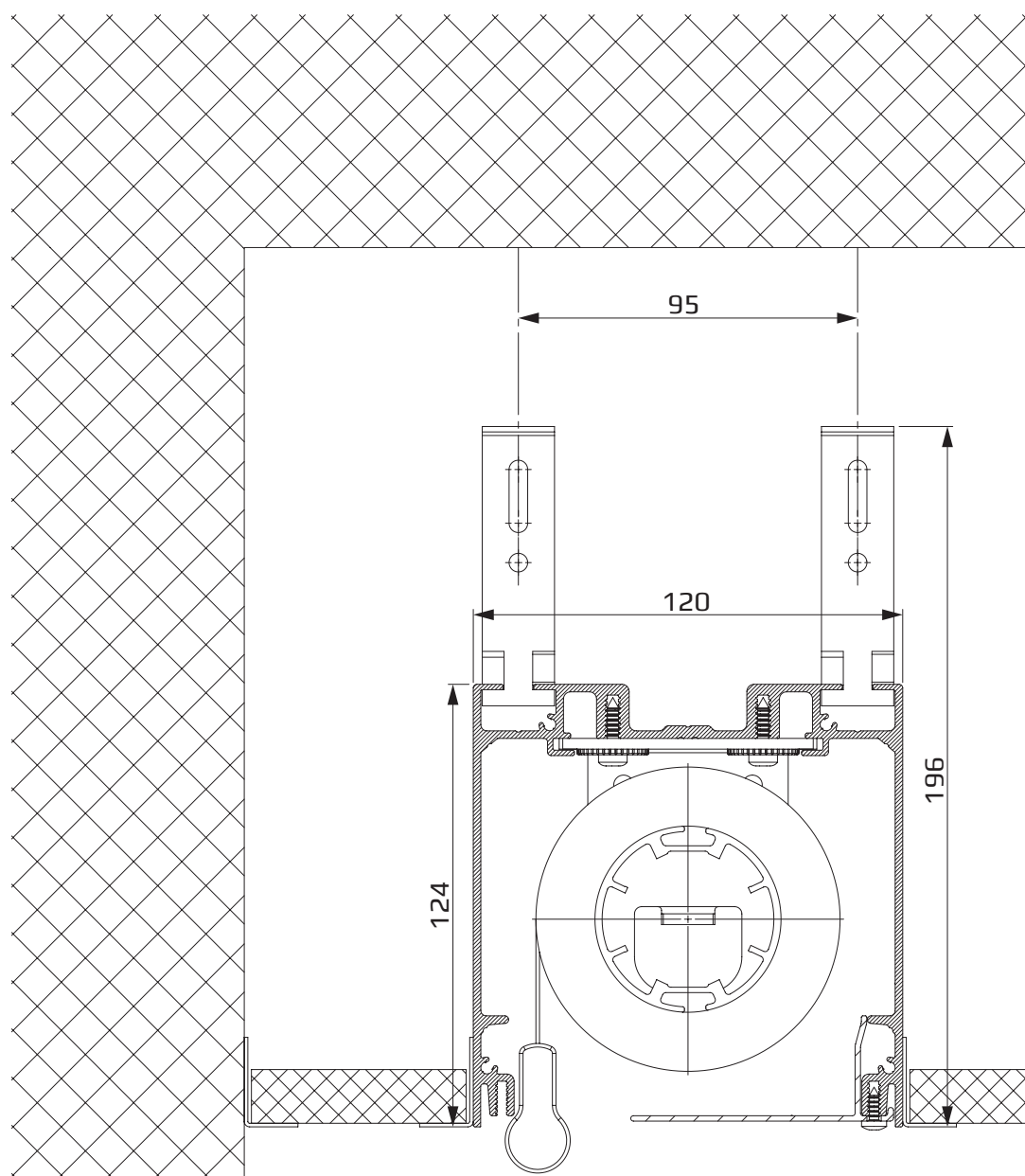

Stipulations of the European Standard **EN 13120:2009+A1:2014**  
 „Internal Blinds – Performance Requirements including Safety“



# WARNING



- Young children can strangle in the loop of pull cords, tapes and cords that operate window coverings.  
They can also wrap cords around their necks.
- To avoid strangulation and entanglement, keep cords out of reach of young children.
- Move beds, cots and furniture away from window covering cords.
- Do not tie cords together.  
Make sure cords do not twist and create a loop.
- Install and use the included safety devices according to the installation instructions on these device to reduce possibility of such an accident.





**All types with operations: Chain**

The operation chain must be **fixed with the included safety device!**

The operation length is in compliance with the Child Safety freely selectable.

Mounting height is **known**:

-> max. operation length = mounting height - 1.50 m

Mounting height is **unknown**:

Blind height  $\leq 2.50$  m -> max. operation length = 1.00 m

Blind height  $> 2.50$  m -> max. operation length = blind height - 1.50 m

Mounting height is **known**

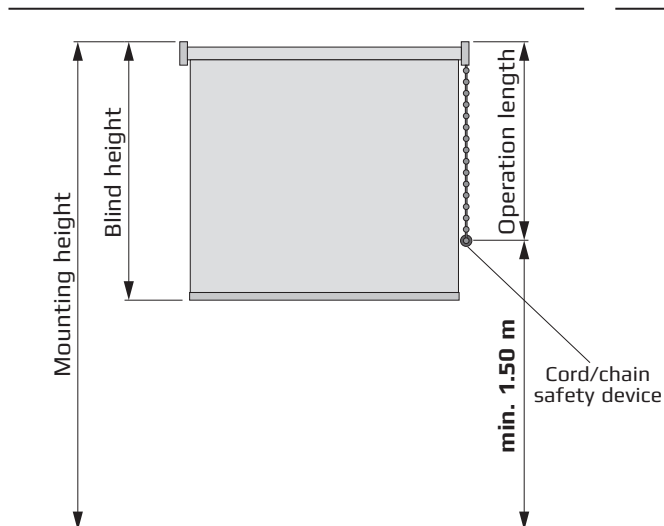

Mounting height is **unknown**

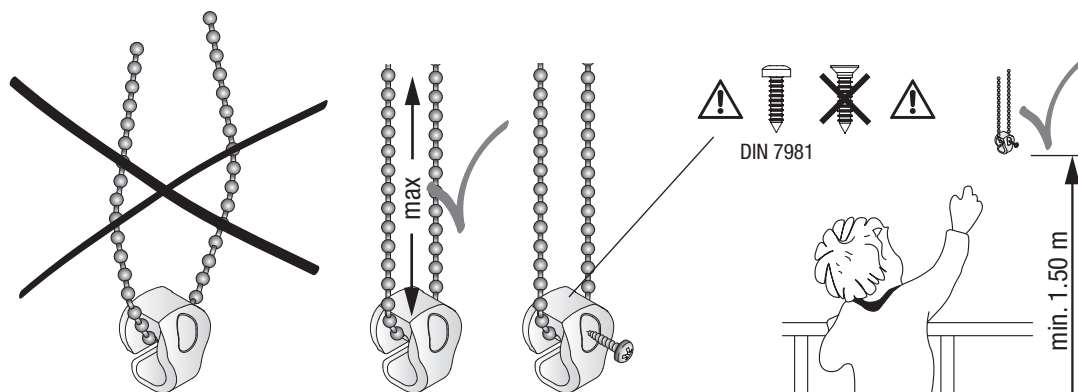
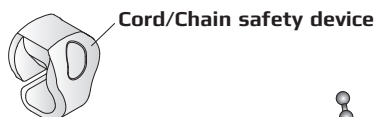
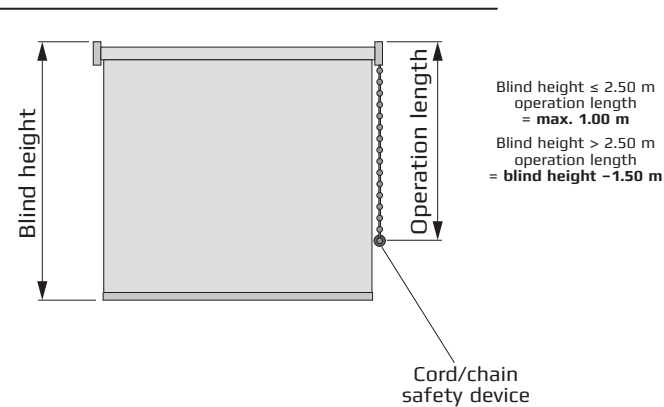



Benthin GmbH  
Osterstader Str. 16  
D-27572 Bremerhaven  
T +49 471 79 84 0  
F +49 471 79 84 111  
E [info@benthin.com](mailto:info@benthin.com)

Benthin  
8 Charter Gate  
Clayfield Close  
Moulton Park  
Northampton NN3 6QF  
T +44 1604 490580  
F +44 1604 648446  
E [info-uk@benthin.com](mailto:info-uk@benthin.com)

Benthin Systèmes E.U.R.L.  
27, Avenue de Montboulon  
FR-77165 St. Soupplets  
T +33 1 60 61 56 56  
F +33 1 60 01 57 11  
E [info@benthin.fr](mailto:info@benthin.fr)

[www.benthin.com](http://www.benthin.com)